



SUMMER CLASSIC™

August 4 –7,
2023



AKC SUMMER CLASSIC EVENTS

FOUR ALL-BREED CHAMPIONSHIP SHOWS	LIMITED-BREED SHOW FOR SCENT HOUNDS	August 4, 2023
FIVE OBEDIENCE TRIALS under a Big-Top Tent	LIMITED-BREED SHOW FOR GROUP 6	August 5, 2023
SIX RALLY OBEDIENCE TRIALS under a Big-Top Tent	LIMITED-BREED SHOW FOR GROUP 3	August 6, 2023
TEN AGILITY TRIALS (see separate Agility Premium List)	LIMITED-BREED SHOW FOR GROUP 7	August 7, 2023

SPONSORED BY:

*Puppy/Juvenile & Veteran Sweepstakes	August 3
*Obedience Fun Match	August 3
*Rally-Obedience Fun Match	August 3
*Agility Fun Run	August 3
Royal Canin Pancake Breakfast	August 4
"BE LIKE LARRY" Day	August 5
FANCY HAT Day	August 6



ASSOCIATED CONFORMATION GROUP & SINGLE BREED SPECIALTIES:

Group 1	Westwind Sporting Dog Club (Sweepstakes)	Friday	August 4, 2023
	Westwind Sporting Dog Club	Saturday	August 5, 2023
Group 4	All Terrier Club of Alberta	Friday	August 4, 2023
Group 5	Southern Alberta Toy Dog Fanciers	Saturday	August 5, 2023

FRIDAY August 4, 2023

All Terrier Club of Alberta, Borzoi Canada Specialty (Regional), Brittany Spaniel Club of Canada (National), Dalmatian Club of Western Canada (Regional), Great Dane Club of Canada (National), Ibizan Hound Club of Canada (Regional), Prairie Labrador Retriever Club, Pembroke Welsh Corgi Association (Regional), Shiba Inu Canada (Regional), Wire-Haired Pointing Griffon Club of Canada (National)

SATURDAY August 5, 2023

Alberta Boxer Club (Regional), Alberta Doberman Pinscher Club (Regional), American Staffordshire Terrier Club (National), Beagle Club of Western Canada (Regional), Border Terrier Canada (National), Cairn Terrier Club of Canada Specialty (Regional), French Bulldog Fanciers of Canada (National), Great Dane Club of Canada (Regional), Schipperke Club of Canada (National)

SUNDAY August 6, 2023

Afghan Hound Club of Canada (National), American Staffordshire Terrier Club (Regional), Beagle Club of Canada (National), Canadian Scottish Terrier Club (Regional), Canadian Shetland Sheepdog Association (Regional), Dalmatian Club of Canada (National), Foothills Gazehound, Irish Wolfhound Club of Canada - Midwestern Branch (Regional), Keeshond Club of Canada (National), Pointer Club of Canada (Regional), Shiba Inu Canada (National), Staffordshire Bull Terrier Club of Canada (National)

SPECIALTY OBEDIENCE TRIAL

Doberman Pinscher Club of Canada Friday August 4, 2023

SPECIALTY RALLY OBEDIENCE TRIAL

Doberman Pinscher Club of Canada Friday August, 4, 2023

**JOIN US FOR A
CALGARY PANCAKE BREAKFAST**

FRIDAY, August 4, 7:30 AM
When they are gone, they are gone!



petsecure™
CANADA'S PET INSURANCE



In August 2020, the Canadian Dog Show World lost a colourful and wonderful Handler. Larry, a true sportsman, was always willing to help anyone or give a mini handling lesson on the fly.

Larry could be picked out of the crowd in an instant; he was famous for extraverted suits, colourful ties, and his contagious laugh. Dogs loved him, maybe something to do with his famous “crack bait” treats, always available in a pocket and generously shared.



Larry was a friend of, and volunteer for the Alberta Kennel Club...the RV parking experience will never be quite the same. We invite you to emulate Larry’s zest for the Show and look in your closet to see if there is something there that would be Larry approved. If not, get shopping so you can be Like Larry on Saturday. Smile Like Larry and have a great show and help us celebrate his memory.

Try the AKC YAPP App

Premium List, Judging Schedule, Site Maps, Field Maps... etc.

<http://my.yapp.us/NA7E75>



**SPACE UNDER THE SHADE TENTS WILL BE AT A PREMIUM THIS SUMMER.
THIS AREA IS ONLY FOR EXHIBITORS & DOGS WAITING TO ENTER THE SHOW RINGS.**

Anyone found “parked” under the main tents will be asked to remove their dogs and possessions.

PLEASE BRING YOUR OWN CHAIR & SHADE SUCH AS AN UMBRELLA OR BRIMMED HAT and PLAN TO SIT AROUND THE PERIMETER OF THE RINGS

****SPRUCE MEADOWS IS A NON-SMOKING FACILITY****

Absolutely no smoking in the ANY BARN or on the COMPETITION FIELDS at any time
Cannabis forbidden on the Spruce Meadows Grounds as it is poisonous to horses

Eleonore and Frank Rebischke
"IrishWarlord"
January 2023



In January 2023, the purebred dog show world lost a great ambassador to the Irish Setter Breed and a great sportsman for her newly found love of the Sussex. In her later years when her knees were giving the hint of decline; and she felt she could no longer keep up with her beautiful big red dogs she decided to get a walking breed. Eleonore moved forward with another red breed "of course" to keep her in the sport of Purebred dogs. She moved forward with the Sussex. I miss my dear friend Eleonore Rebischke January 6, 2023

If you can only listen to one song please listen to "If You Could Read My Mind" by Gordon Lightfoot which was one of her favorites to celebrate her life and IrishWarlord Kennels. Thank you, Eleonore for being that friend.

*Jacqueline Fussel

Eleonore was a long time member of the Alberta Kennel Club and held the President's position in 1985-1986. She was always a supporter of the Club; we mourn her passing and remember her zest for life and her love for her red dogs.



"The Best Odour Eliminator on the Market"

Safe & Non-Toxic

Pet & Kid Friendly

Fabric Safe

Made of Naturally Occuring Bacteria

Professional Grade

Highly Concentrated

Indoor & Outdoor

Eliminates Odours (doesn't mask them)

ez-clean
bioenzyme concentrate cleaner

ez-clean uses

- dog runs and kennels
- litter boxes
- carpet stains
- upholstery stains
- garbage cans
- sport equipment
- laundry
- decks
- fences
- real grass
- synthetic grass
- mildew smell
- smoke smell
- skunk smell
- vehicles
- RV toilets
- septic tanks

"Just spray it on and walk away... it's that EZ"

www.ez-clean.ca

Thursday, August 3, 2023

- **Armbands** can be picked up starting at 4pm:
 - All Breed Conformation ONLY - at the AKC Show Secretary Desk
- **Pre-ordered digital catalogues** will be available for download, Thursday, August 3, 2023, no sooner than 1.5 hrs. prior to start of judging.
- Puppy & Juvenile, Veterans Sweepstakes starting 5:30 pm
- Rally-Obedience Fun Match, registration at 5:30-6:00 pm and match begins at 6:00 pm
- Obedience Fun Match, registration at 5:30-6:00 pm and match begins at 6:00 pm
- Agility Fun Run (see Agility Premium List for details)

Friday, August 4, 2023

SPONSORED BY:



**JOIN US FOR A
CALGARY PANCAKE BREAKFAST**

FRIDAY 7:30 AM

August 4, 2023



- **Armbands** can be picked up as follows:
 - All Breed Conformation - at the AKC Show Secretary Desk
 - Specialty Conformation - Ringside unless otherwise notified in the specialty judging schedule
 - Obedience - Ringside at the Obedience Rings (All-Alberta Field)
 - Rally-O - Ringside at the Rally-O rings (All-Alberta Field)
 - Agility - Ringside at the Agility Rings (All-Alberta Field) no arm band, just check in required
- OFA Eye Certification Clinic – including Glaucoma – 9 am to 5 pm Upper West Side of the North American Viewing Building – Please see advertisement for registration details.
- Echocardiogram with Color Flow Doppler Breed Screen Clinic, Upper East Side of North American Viewing Building.

Saturday, August 5, 2023

“BE LIKE LARRY” DAY

- Echocardiogram with Color Flow Doppler Breed Screen Clinic, Upper East Side of North American Viewing Building.
- **BOAS CLINIC** (Respiratory Function Grading Scheme, RFGS), 9am – 4:30pm. Location to be Announced. Information on clinic at the back of this document under Health Testing

Sunday, August 6, 2023

FANCY HAT DAY

**Ladies and Gentlemen,
Channel your inner diva or dandy
and wear a fascinator or chapeau.
Wear all weekend if you like**



- Echocardiogram with Color Flow Doppler Breed Screen Clinic, Upper East Side of North American Viewing Building.
- **BOAS CLINIC** (Respiratory Function Grading Scheme, RFGS), 9am – 4:30pm. Location to be Announced. Information on clinic at the back of this document under Health Testing

RV Parking:

1. *RV Parking – Thursday, August 3, 2023 @ 9 am to 10 pm, at which time the entrance gate will be closed. All arrivals after 10 pm, please proceed to the North American Entrance to be escorted to your parking space.*
2. If you have prepaid for a spot in our Handicapped area, you must provide a valid, government issued handicapped placard, and if you do not have one of these, we will have to assign you a space in Lot 10 or 11.
3. All motorhomes and trailers in Lot 10 (grass) must have boards placed under the tires. Please bring leveling materials for your unit.
4. Motorhome generators must be vented up with an exhaust pipe extension (mandatory, no matter the lot).
5. Please ensure **GENERATORS ARE OFF** between the hours of **11:00 PM and 6:00 AM** – this is the designated “quiet time” for our friends and neighbours.
6. Complimentary Shower Trailer provided by the Alberta Kennel Club – ask at the AKC desk for directions or follow the signs – the showers are East of the Fountain “Dog Spa”.
7. There is no overnight tenting or sleeping in vehicles permitted at Spruce Meadows.
8. No Open Fires of any kind (wood or propane) are permitted on the grounds of Spruce Meadows.
9. Absolutely NO dumping of grey water or sewage on Spruce Meadows grounds.
10. Water & electrical hook-ups are NOT available on Lots 10, 11 or handicapped area for RV units.
11. All RV parking is at your own risk:
THE ALBERTA KENNEL CLUB IS NOT RESPONSIBLE FOR WEATHER RELATED DAMAGE TO PERSONAL PROPERTY. PLEASE BE PREPARED FOR UNFORSEEN EVENTS ESPECIALLY WIND AND/OR HAIL.
12. If you must leave the show grounds, dogs in your care must be moved inside. DOGS MAY NOT BE LEFT UNATTENDED IN ANY OUTDOOR ENCLOSURE. FAILURE TO COMPLY will result in IMMEDIATE EXCUSAL from the show.
13. All Set -ups are required to have a contact phone number posted in case of emergency.
14. No balloons of any sort are permitted on the grounds of Spruce Meadows – they frighten the horses!

Parking:

1. Free parking is permitted in Lot 7, between B-Barn and C-Barn, and along the east side of K-Barn and E-Barn only. **PLEASE NOTE THAT PARKING LOT 7 WILL BE CLOSED FROM 9PM FRIDAY AUG 4 TO 5AM SATURDAY AUG 5 FOR MAINTENANCE.**
2. Designated Handicapped parking areas are between K Barn (South Side) and the Wash Bays, the North End of B & C Barn. Please observe and respect the Handicapped (clearly marked) and Designated Parking (clearly marked) areas.
3. The Alberta Kennel Club, and Spruce Meadows reserve the right to have vehicles towed that are in areas other than described, this includes those areas that are designated “No Parking.”
4. The speed limit on the grounds (including the RV Parking area) of Spruce Meadows is 15 km/hour.

5. Any indignities to the Staff of Spruce Meadows or to the volunteers of the Alberta Kennel Club will result in IMMEDIATE EXPULSION from the shows. Thank you for your cooperation!
6. All parking is a privilege at Spruce Meadows. Anyone abusing these privileges will be excused immediately from the show, and all future shows on this venue by the parking authorities and/or show superintendent.

K-Barn Reserved Benching:

1. K-Barn Reserved Benching – Thursday, August 3, 2023 @ 1 pm
2. Please bring your own power cords (at least 100' in length) and sturdy duct tape. All power cords in the aisles of the K-barn must be taped to the floor with duct tape for the length of the cord as it lays on the concrete floor. This is for the safety of all those benching in the barn and is required by Spruce Meadows.
3. If you are leaving dogs in the stalls, your contact information must be visible in your benching area in the event of an emergency.
4. Absolutely no smoking (either tobacco or cannabis) in the barn at any time!
5. You are responsible for leaving your stall as you found it.... **CLEAN!** Brooms, dust pans and a couple of shop vacs will be available in K-Barn to assist you in cleaning your benching space. Please remove all duct tape from the floor when lifting your power cord.
On Monday after move-out, those exhibitors leaving a dirty stall behind will be noted by the show committee and future requests for benching in the K-Barn may be denied.
6. **All indoor benching must be vacated 1 hour following Best in Show on Monday, Aug 7, 2023.**

All-Alberta Ring & North American Ring Outdoor Reserved Day Tenting:

Private golf carts are not permitted on any field at any time.

1. Outdoor Reserved Benching move in – Thursday, August 3, 2023 @ 2 pm.
2. Absolutely no vehicles on the fields at any time, please ensure you have a cart/trolley to move your items to your reserved benching spot.
3. Once the show commences you are welcome to drive into the designated Pick-up / Drop-off area on the north and south side of the wash bay areas. This area will be in operation all day. **THERE WILL BE AN OFF-LOADING AREA WHERE YOUR CARGO CAN BE LEFT UNTIL YOU RETURN FROM PARKING YOUR VEHICLE IN LOT 7. Note that you only have 15 minutes to drop off/pick up. The area will be supervised.**
4. No smoking in the benching area or the competition fields at any time!
5. **Dogs are not to be left overnight in outdoor benching spaces.**
6. **ALL DAY TENTS MUST BE SECURELY TIED DOWN AND TOP DROPPED AT THE END OF EACH DAY.**
7. Grass mats are not permitted in the day tenting areas of the North American and the All Alberta Fields.
8. Generators (civilized ones please, excessively loud generators will not be permitted) are permitted in the day tenting area, however the generators must be housed up against the fence line and at no time are to infringe on your neighbors' space so that exhaust fumes would enter their area. Please ensure you have a long extension cord if you are using a generator.

Security is on site from 7 p.m. to 7 a.m. daily.

9. You are responsible for leaving your space as you found it.... **CLEAN!** Please ensure that you have a rake/tool handy to clean up your area, left behind garbage, dog hair, rubber bands, etc. are not the responsibility of the Alberta Kennel Club Volunteers or Spruce Meadows Personnel to clean up. We thank you for your cooperation in this regard!

10. **All outdoor benching must be vacated 1 hour following Best in Show on Monday, Aug 7, 2023.**

Un-Reserved Outdoor Benching:

West side of K-Barn only – available Thursday August 3, 2023 @ 2 pm

Dog Bathing:

-We have 4 stalls available on the south side of the horse wash bays, complete with hot and cold running water, all complete with bath tubs. Please be advised that this water is non-potable and not for drinking.

Concessions:

- The Time Faults Pub is open at 7 am to 11 am daily for breakfast, and open the rest of the day until 9 pm for lunch or dinner. (Friday to Monday) ****unless private functions are scheduled for the evening****

- There are concession stands on the East end of the horse wash bays as well as the SE entrance of the North American Field. (Friday to Monday)

Recycle, Garbage & Dog Poop:

- You are **TOTALLY** responsible for picking up after your dog. Spruce Meadows and the Alberta Kennel Club have **ZERO** tolerance for dog droppings on the grounds. Let us be responsible and set a great example keeping the grounds pristine. **Exhibitors who are found not picking up after their dogs will be asked to leave the show immediately.**

- All Exhibitors are responsible for putting their recyclables, garbage, and hair in the large garbage bins. Please leave your benching areas clean at the end of the show as a courtesy to Spruce Meadows and the volunteers who run the show.

Urgent Medical Call Procedure:

- Have one person with the guest requiring medical attention call 9-1-1 and direct the ambulance to the Front Gate off Spruce Meadows Way at 18011 Spruce Meadows Way. If there is another person at the scene, please have them call the AKC on-site contact Tina Gaudet at 403 619-3212. If there is not a second person on-site, please call Tina immediately after calling 9-1-1 to ensure we can deploy protocol to meet the ambulance.

- An AKC representative will head to the scene and stay with the guest requiring medical attention and will also call the Spruce Meadows Security Line to have the security team meet and escort the ambulance from the front gate to the scene.

Non-Urgent Medical Call Procedure:

- Call AKC contact, Tina Gaudet at 403 619-3212 and have her get in contact with Spruce Meadows Security to meet at the scene of the guest requiring attention.

- Assess the situation and call the ambulance as required. Spruce Meadows Security Line to have the security team meet and escort the ambulance from the front gate to the scene.



*Alpine Pet Hospital **18km**
 5707 Macleod Trail SW
 Calgary, AB T2H 0J7
 403-212-4008
www.alpine247.ca

*Western Veterinary Specialist & Emergency Centre **26km**
 1802 10th Avenue SW
 Calgary, AB T3C 0J8
 403-770-1340
www.vccanada.com/western

*Southern Alberta Veterinary Emergency **23km**
 322233 – 15th Street E
 Okotoks, AB T1S 1A6
 403-995-3270
www.saveveterinary.com

*Trinity Hills 24 Hour Pet Hospital **26.7km**
 240 Na'a Plaza SW
 Calgary, AB T3H 6A4
 403-233-2888
www.thph.ca

*CARE Centre **24km**
 7140 - 12th Street SE
 Calgary, AB T2H 2Y4
 403-520-8387
www.vccanada.come/care

Other Notes:

-The Alberta Kennel Club is pleased to be holding our show once again at Spruce Meadows. Holding our event here comes with some significant responsibilities for all of us – volunteers and exhibitors alike.

-This is a world class Equestrian Centre which welcomes people from around the world and we must treat this venue with the respect it is due.

- Clean up after your dog. KEEP BAGGIES WITH YOU AT ALL TIMES.
- Do not allow the male dogs to lift their legs on fences, posts, trees, or shrubs.
- *Failure to pick-up after your dogs will result in expulsion from the show and the show grounds.*

Please confine yourself to the AKC Show site.

Other events may be reserved elsewhere on the Spruce Meadows property

The Alberta Kennel Club will not be responsible for the loss or injury to any dog, or for the possessions of any exhibitor whether a result of accident or any other cause. It is expressly understood that every dog at these shows is in the care, custody, and control of the owner or handler during the entire time the dog is on the show premises.

The welfare of an exhibitor's child is the responsibility of the exhibitor. Exhibitors will exercise control and restraint over their children.

ANIMALS LEFT IN VEHICLES – *The Owner of an Animal must not leave an Animal unattended in a motor vehicle when the temperature outdoors is below minus 15 degrees Celsius or above plus 15 degrees Celsius. City of Calgary BYLAW NUMBER 47M2021. Animals left in a vehicle will be monitored. If animals are in distress due to heat or any other circumstance, the vehicle will be forcibly entered, the animal recovered and the owner will be subject to penalty under the Animal Protection Act 2(1) (1.1) 2.1©. The Alberta Kennel Club will not accept any responsibility for damage to any vehicle entered to remove an animal(s) in distress*

Junior Showmanship Events at Participating Specialty Shows

<u>Friday August 4, 2023</u>	<u>Saturday August 5, 2023</u>	<u>Sunday August 6, 2023</u>
Brittany Spaniel Club of Canada	The Alberta Boxer Club Alberta Doberman Pinscher Club Border Terrier Canada Westwinds Sporting Dog Club	Beagle Club of Canada Dalmatian Club of Canada Keeshond Club of Canada Foothills Gazehound

Each club will have a different location for accepting entries for their Junior Handling event - most will be ringside just before their specialty. But each will be listed in their individual Judging schedule - entries will NOT be being taken at the Show Secretary or AKC table - and there is no Junior Tent this year.

**** ATTENTION CONFORMATION AND RALLY-OBEDIENCE EXHIBITORS ****

Due to Judging overloads, some of the breed judging has been modified. The Group assignments remain the same as posted in the premium list. **Please check the Judging Assignments following below.**

The following CKC rules apply for the replacement judge and for the overload:

CKC RULE 3.3.1 "... Exhibitors affected by this change may withdraw their entries up to one (1) hour before the JUDGING OF THE BREED, notice of withdrawal must be made in writing. All entry and listing fees for withdrawn dogs shall be refunded. An exhibitor may enter a dog under the replacement judge providing that the dog is entered in one (1) of the regular classes of a show being held at the same venue by the same club and has been assigned a competition number. A new entry, along with accompanying fees, will be accepted by the Show Secretary up to one (1) hour prior to the START OF THE SHOW."

CKC RULE 3.5.1 When entries close, and the club determines that the total number of dogs entered under a judge exceeds 175 at breed level, the club in question must seek approval from the CKC to transfer a sufficient number of dogs to another judge to reduce the total number to 175. One or more regular classes shall be reassigned until the original assignment is brought as closely as possible to 175 dogs. Exhibitors affected by the change may withdraw their entries up to one (1) hour before judging of the breed, providing that notice of withdrawal is made in writing. All entry and listing fees for withdrawn dogs shall be refunded. Similarly, a dog entered at the show but not under the judge drawing an overload, may enter under the substitute judge as provided for in Section 8.5.

Judging Assignments – Group and Best in Show				
CONFORMATION	Friday	Saturday	Sunday	Monday
Best In Show	John Burgess	Michael Canalizo	Rui Alberto Oliveira	Dana P Cline
Best Puppy in Show	John Burgess	Michael Canalizo	Rui Alberto Oliveira	Dana P Cline
Best Veteran in Show	John Burgess	Michael Canalizo	Rui Alberto Oliveira	Dana P Cline
Best Baby Puppy in Show	John Burgess	Michael Canalizo	Rui Alberto Oliveira	Dana P Cline
Group 1	Rui Alberto Oliveira	*John Palmer / Cindy Vogels / Aramis "Joy" Lim	John Burgess	*Dana P Cline / Aramis "Joy" Lim
Group 2	*John Palmer / Dana P Cline	Cindy Vogels	Murray Eason	Irene Latchford
Group 3	Lois Wilson	Rui Alberto Oliveira	*Marjorie Martorella / Irene Latchford	*Aramis "Joy" Lim / John Palmer
Group 4	H. Brian Reid	John Burgess	Rui Alberto Oliveira	*Lois Wilson / John Palmer
Group 5	John Burgess	Michael Canalizo	*Irene Latchford / Lois Wilson	John Palmer
Group 6	*Michael Canalizo / Dana P Cline	*Lois Wilson / Irene Latchford	Aramis "Joy" Lim / Rui Alberto Oliveira	*Irene Latchford / John Burgess / Dana P Cline
Group 7	*Michael Canalizo / Aramis "Joy" Lim	Irene Latchford	John Palmer	Rui Alberto Oliveira
Limited-Breed Show – Scent Hounds	Aramis "Joy" Lim			
Limited-Breed Show – Group 6		John Palmer		
Limited-Breed Show – Group 3			*Dana P Cline / Irene Latchford	
Limited-Breed Show – Group 7				*John Burgess / Aramis "Joy" Lim
*DENOTES GROUP JUDGE in a Group split between 2 or more Judges				

A ramp will be available for use at the Judge's discretion.

Judging Assignments – Breed & Group

FRIDAY

Group 2

*John Palmer Dana P Cline	Group and all breeds except Ibizan & Irish Wolfhound Ibizan & Irish Wolfhound
------------------------------	--

Group 6

*Michael Canalizo Dana P Cline	Group and all breeds except Standard Poodles Standard Poodles
-----------------------------------	--

Group 7

*Michael Canalizo Aramis "Joy" Lim	Group and Miniature American Shepherd to Welsh Corgi (Pembroke) Australian Cattle Dog to Icelandic Sheepdog
---------------------------------------	--

SATURDAY

Group 1

*John Palmer Cindy Vogels Aramis "Joy" Lim	Group and Barbet to Retriever (Nova Scotia Duck Tolling) except German Shorthaired Pointers, Retriever (Golden), & Retriever (Labrador) Setter (English) to Weimeraner German Shorthaired Pointers, Retriever (Golden), & Retriever (Labrador)
--	--

Group 6

*Lois Wilson Irene Latchford	Group and all breeds except Shiba Inu, Schipperke and Keeshond Shiba Inu, Schipperke and Keeshond
---------------------------------	--

SUNDAY

Group 3

*Marjorie Martorella Irene Latchford	Group and Akita to Newfoundland Portuguese Water Dog to Yakutian Laika
---	---

Group 5

*Irene Latchford Lois Wilson	Group and Affenpinscher to Papillon Pekingese to Yorkshire Terrier
---------------------------------	---

Group 6

Aramis "Joy" Lim Rui Alberto Oliveira	Group and all breeds except French Bulldogs French Bulldogs
--	--

Limited Group 3

*Dana P Cline Irene Latchford	Group and all breeds except Great Dane Great Dane
----------------------------------	--

MONDAY

Group 1

*Dana Cline Aramis "Joy" Lim	Group and all breeds except Griffon (Wire-haired Pointing) Griffon (Wire-haired Pointing)
---------------------------------	--

Group 3

*Aramis "Joy" Lim John Palmer	Group and all breeds except Boxer and Great Dane Boxer and Great Dane
----------------------------------	--

Group 4

*Lois Wilson John Palmer	Group and all breeds except American Staffordshire Terrier American Staffordshire Terrier
-----------------------------	--

Group 6

*Irene Latchford John Burgess Dana P Cline	Group and American Eskimo Dog (Miniature) to Poodle (Standard) excluding Keeshond Keeshond, Schipperke to Xoloitzcuintli (Standard) except Shiba Inu Shiba Inu
--	--

Limited Group 7

*John Burgess Aramis "Joy" Lim	Group and all breeds except Welsh Corgi (Pembroke) Welsh Corgi (Pembroke)
-----------------------------------	--

*DENOTES GROUP JUDGE in a Group split between 2 or more Judges

Limited-Breed Championship Show for Scent Hounds

FRIDAY, August 4, 2023

JUDGE: Aramis "Joy" Lim

ASSIGNMENT:

Basset Hound, Beagle, Black and Tan Coonhound, Bloodhound, Dachshunds (Miniature Long-haired, Miniature Smooth, Miniature Wire-haired, Standard Long-haired, Standard Smooth & Standard Wire-haired), Drever, Foxhounds (American & English), Norwegian Elkhound, Harrier, Norrbottenspets, Norwegian Lundehund, Otterhound, Petit Basset Griffon Vendeen, Shikoku

CLASSES OFFERED – Junior Puppy, Senior Puppy, 12-18 Months, Canadian Bred, Bred By Exhibitor, Open, Specials, Veterans, Baby Puppy

PRIZES OFFERED – Rosette for Best of Breed , Rosette for Best Overall Scent Hound

Limited-Breed Championship Show for Group Six

SATURDAY, August 5, 2023

JUDGE: John Palmer

ASSIGNMENT:

Group and All Breeds in Group Six

CLASSES OFFERED – Junior Puppy, Senior Puppy, 12-18 Months, Canadian Bred, Bred By Exhibitor, Open, Specials, Veterans, Baby Puppy

PRIZES OFFERED – Group Placement Rosettes

Limited-Breed Championship Show for Group Three

SUNDAY, August 6, 2023

JUDGES: *Dana P Cline / Irene Latchford

ASSIGNMENT:

Dana P Cline – Group and All Breeds in Group Three except Great Dane;

Irene Latchford – Great Dane

CLASSES OFFERED – Junior Puppy, Senior Puppy, 12-18 Months, Canadian Bred, Bred By Exhibitor, Open, Specials, Veterans, Baby Puppy

PRIZES OFFERED – Group Placement Rosettes

Limited-Breed Championship Show for Group Seven

MONDAY, AUGUST 7, 2023

JUDGE: *John Burgess / Aramis "Joy" Lim

ASSIGNMENT:

John Burgess – Group and All Breeds in Group Seven except Welsh Corgi (Pembroke);

Aramis "Joy" Lim – Welsh Corgi (Pembroke)

CLASSES OFFERED – Junior Puppy, Senior Puppy, 12-18 Months, Canadian Bred, Bred By Exhibitor, Open, Specials, Veterans, Baby Puppy

PRIZES OFFERED – Group Placement Rosettes

*DENOTES GROUP JUDGE in a Group split between 2 Judges

Judging Assignments – Obedience and Rally-Obedience

Obedience	Friday	Saturday	Sunday	Monday
	Trial #1	Trial #2	Trial #4	Trial #5
	Suzanne Hemminger	Cheryl Bishop	Suzanne Hemminger	Cheryl Bishop
		Trial #3		
		Marion Postgate		

Rally-Obedience	Friday	Saturday	Sunday	Monday
	Trial #1	Trial #3	Trial #4	Trial #6
	Cheryl Bishop	Suzanne Hemminger	Marion Postgate	Suzanne Hemminger
		*Marion Postgate – Novice Rally-O A&B		
	Trial #2		Trial #5	
	Tami Marks		Cheryl Bishop	

***RALLY** - The exhibitor shall be permitted to withdraw such entries at any time prior to the day of the trial and the entry fees and listing fees paid for entering such dogs shall be refunded. The club, in such notice to exhibitors, must also announce which of the two judges of a given class will judge the run-off of any tie scores that may finally develop between the two groups of dogs.

<http://my.yapp.us/NA7E75>

All JUDGING SCHEDULES will be posted at:
www.dogshow.ca -- www.canuckdogs.com
 -- www.albertakennelclub.org --



CKC 8.13.5 RALLY-OBEDIENCE RING PROCEDURE:

- The judge will post the course(s) outside the ring at least 10 minutes prior to the first walk-through for each class. The judge may alter the course because of unforeseen ring conditions and post any change(s).
- *In the interest of becoming more environmentally friendly, the Rally course maps will be posted at ringside; however, the Alberta Kennel Club will not be providing exhibitor paper copies.*

Exhibitors, Please note:

- All Adult Group judging and Best in Show judging will be held in Ring # 8, Best Puppy in Group and Best Puppy in Show will be in Ring #7 on the North American field. Throughout the day; Individual breeds, dogs and classes will NOT be paged. Exhibitors and handlers with more than one dog must have an alternate handler available.
- For your convenience the division of sexes has been carefully tabulated, however the Alberta Kennel Club does not assume responsibility for absolute accuracy. The number before each breed is the total number of that breed; following the breed is the following division - males - females - special males - special females. * Denotes booster and/or supported entry.
- Dogs must enter the show premises 1 (one) hour prior to the scheduled judging of the breed. Dogs which are not required for further judging may leave the show grounds after their judging is completed.
- Exhibitors and handlers are solely responsible for having their dogs at ringside at the scheduled time (absent dogs must be allowed for). It is not the responsibility of the Alberta Kennel Club or the ring steward to locate dogs.
- Exhibitors noting possible dog conflicts between Conformation and Obedience and Rally must notify the Obedience / Rally-Obedience Chairman, Maureen O'Neil before the start of judging in the ring in question on the day in question. Judges will complete morning assignments before breaking for lunch.



****SPRUCE MEADOWS IS A NON-SMOKING FACILITY****

Absolutely no smoking in the ANY BARN or on the COMPETITION FIELDS at any time
Cannabis forbidden on the Spruce Meadows Grounds as it is poisonous to horses



SPACE UNDER THE SHADE TENTS WILL BE AT A PREMIUM THIS SUMMER.
THIS AREA IS ONLY FOR EXHIBITORS & DOGS
WAITING TO ENTER THE SHOW RINGS.

Anyone found “parked” under the main tents will be asked to remove their dogs and possessions.

PLEASE BRING YOUR OWN CHAIR & SHADE SUCH AS AN UMBRELLA OR BRIMMED HAT and PLAN TO SIT AROUND THE OUTSIDE PERIMETER OF THE RING.

Group/Event	Thursday	Friday	Saturday	Sunday	Monday	Totals
Group 1		123	128	125	118	494
Group 2		94	102	96	71	363
Group 3		135	145	135	116	531
Group 4		99	102	103	88	392
Group 5		93	101	94	86	374
Group 6		119	127	136	116	498
Group 7		89	100	96	89	374
Limited Breed – Scent Hounds		42				42
Limited Breed – Group 6			118			118
Limited Breed – Group 3				136		136
Limited Breed – Group 7					85	85
Exhibition Only		12	12	13	5	42
Baby Puppy		43	53	40	33	169
Veteran		24	33	35	26	118
Total		873	1031	1009	833	3746
Puppy/Juvenile, Veteran Sweepstakes	82					82
Specialties		457	635	484		1576
Total Conformation	82	1330	1666	1493	833	5404
Obedience *		26	37	21	17	101
Rally-O *		127	91	102	45	365
Specialty Rally/Obedience		20				20
Agility *		247	302	199	207	955
Weekend Total		1750	2096	1815	1102	6763

* Note – Agility does not close until July 25, so this is not a total count. Day of entries are allowed for Rally, Obedience and Agility so these numbers will change.

In the interest of becoming more environmentally friendly,
 no printed Judging Schedules will be available at the Show Secretary’s Desk.

**PLEASE PRINT A COPY OF YOUR JUDGING SCHEDULE & SITE MAPS
 OR DOWNLOAD ON AN ELECTRONIC DEVICE.**

Any breeds in BOLD in the schedule are for a BOOSTER.

<http://my.yapp.us/NA7E75>



JUDGING SCHEDULE - Alberta Kennel Club [SUMMER CLASSIC]

Conformation - Thursday, August 03, 2023

Ring 5 5:30p.m.

JUVENILE SWEEPSTAKES FEMALES
- JUDGE ALLISON ALEXANDER-
41 DOGS
JUNIOR PUPPY FEMALE - 18 DOGS
SENIOR PUPPY FEMALE - 7 DOGS
12-18 MONTH FEMALE - 16 DOGS

BEST IN SWEEPS TO FOLLOW

Ring 6 5:30p.m.

JUVENILE SWEEPSTAKES MALES
- JUDGE WILL FRIEND -
27 DOGS
JUNIOR PUPPY MALE - 15 DOGS
SENIOR PUPPY MALE - 3 DOGS
12-18 MONTH MALE - 9 DOGS

Ring 6 Immediately following Juvenile Male Sweepstakes

VETERAN SWEEPSTAKES
- JUDGE WILL FRIEND -
14 DOGS
7 - 10 YEAR MALE - 6 DOGS
10 - 12 YEAR MALE - 1 DOG
12+ YEAR MALE - 1 DOG
7 - 10 YEAR FEMALE - 4 DOGS
10 - 12 YEAR FEMALE - 2 DOGS

BEST IN SWEEPS TO FOLLOW

Judging Location:

TBL

TBL/RMP

RMP

RMP/GND

GND

JUDGING SCHEDULE - Alberta Kennel Club [SUMMER CLASSIC]

Conformation - Friday, August 04, 2023

Ring 1
Group 2 (Hounds)
John Palmer

8:00a.m.

8 Whippet	0-1-3-4
1 Veteran	1-0
1 Basset Hound	0-0-1-0
5 Rhodesian Ridgeback	2-1-0-2
1 Bloodhound	1-0-0-0
1 Azawakh	1-0-0-0
2 Greyhound	0-0-0-2
2 Otterhound	1-0-1-0
1 Norwegian Elkhound	0-1-0-0
1 Baby Puppy	0-1
2 Finnish Spitz	0-0-0-2
1 Deerhound (Scottish)	0-0-1-0
8 Borzoi	1-3-1-3
4 Dachshund (SWH)	0-3-0-1
1 Dachshund (SS)	0-0-0-1
2 Dachshund (SLH)	0-0-1-1
1 Baby Puppy	1-0
3 Dachshund (MWH)	2-1-0-0
2 Dachshund (MS)	0-2-0-0
17 Dachshund (MLH)	4-6-4-3
1 Baby Puppy	0-1
1 Veteran	1-0
15 Beagle	3-6-3-3
6 Afghan Hound	3-1-0-2
1 Exhibition Only	0-1

Ring 1
Group 4 (Terriers)
Brian Reid

1:00p.m.

8 Am Staffordshire	0-1-3-4
5 Parson Russell Terrier	3-2-0-0
2 Schnauzer (Miniature)	1-1-0-0
7 West Highland White Terr.	1-5-0-1
1 Baby Puppy	0-1
3 Bull Terrier (Miniature)	0-1-1-1
1 Irish Terrier	0-1-0-0
13 Staffordshire Bull Terrier	4-5-2-2
2 Baby Puppy	1-1

4 Soft-Coated Wheaten	0-1-1-2
2 Kerry Blue Terrier	1-0-0-1
1 Exhibition Only	0-1

Ring 1
Group 4 (Terriers)
Brian Reid

3:45p.m.

1 Bull Terrier	0-0-1-0
----------------	---------

Ring 2
Group 6 (Non-Sporting Dogs)
Michael Canalizo

8:15a.m.

6 Bulldog	2-3-1-0
1 Baby Puppy	0-1
2 Chow Chow	1-0-1-0
1 Baby Puppy	0-1
19 Keeshond	3-7-5-4
2 Veteran	1-1
5 Boston Terrier	2-1-1-1
26 French Bulldog	8-9-4-5
1 Baby Puppy	0-1
1 Lhasa Apso	0-0-1-0
1 Veteran	1-0
4 Shih Tzu	1-2-1-0
2 Bichon Frise	0-1-1-0
17 Dalmatian	1-2-4-10
2 Exhibition Only	1-1
2 Baby Puppy	1-1
3 Xoloitzcuintli (Standard)	1-0-0-2

Ring 2
Group 6 (Non-Sporting Dogs)
Michael Canalizo

1:00p.m.

2 Poodle (Miniature)	1-0-0-1
6 Schipperke	2-3-1-0
17 Shiba Inu	2-5-2-8
1 Baby Puppy	1-0

Ring 2
Group 7 (Herding Dogs)
Michael Canalizo

2:45p.m.

6 Welsh Corgi (Pembroke)	2-0-0-4
4 Welsh Corgi (Cardigan)	1-0-2-1
28 Shetland Sheepdog	9-10-6-3
3 Veteran	1-2
2 Mini American Shepherd	0-2-0-0
1 Schapendoes	0-0-1-0
3 Old English Sheepdog	0-2-1-0
1 Veteran	0-1

Ring 3
Group 1 (Sporting Dogs)
Rui Alberto Oliveira

8:45a.m.

6 Pointer	0-3-2-1
1 Baby Puppy	0-1
11 Weimaraner	1-4-4-2
1 Veteran	0-1
15 Spaniel (Brittany)	4-5-4-2
2 Veteran	1-1
14 Pointer (GSH)	2-6-3-3
2 Veteran	2-0
3 Vizsla (Smooth-Haired)	2-1-0-0
4 Retriever (CB)	0-3-1-0
1 Veteran	1-0
1 Retriever (Flat)	0-0-1-0
9 Retriever (NSDT)	4-3-1-1
1 Spaniel (Irish Water)	0-0-0-1
1 Spaniel (Welsh Springer)	1-0-0-0
5 Setter (English)	2-1-0-2
2 Setter (Irish)	1-1-0-0

Ring 3
Group 1 (Sporting Dogs)
Rui Alberto Oliveira

1:00p.m.

1 Spaniel (Clumber)	0-0-1-0
2 Spaniel (English Springer)	1-0-0-1
2 Baby Puppy	1-1

9 Griffon (WHP)	1-1-2-5
1 Baby Puppy	0-1
18 Retriever (Golden)	10-6-2-0
1 Exhibition Only	1-0
3 Baby Puppy	1-2
17 Retriever (Lab)	1-8-3-5
2 Spaniel (Am Cocker)	0-2-0-0
2 Spaniel (English Cocker)	1-1-0-0

Ring 4
Group 2 (Hounds)
Dana Cline

8:00a.m.

3 Ibizan Hound	0-1-2-0
9 Irish Wolfhound	3-6-0-0

Ring 4
Group 7 (Herding Dogs)
Aramis "Joy" Lim

10:00a.m.

1 Iceland Sheepdog	0-1-0-0
4 German Shepherd Dog	2-1-1-0
1 Baby Puppy	0-1
1 Finnish Lapphund	0-0-1-0
3 Collie (Smooth)	0-2-1-0
3 Collie (Rough)	0-1-1-1
2 Bouvier des Flandres	1-1-0-0
4 Border Collie	2-0-0-2
1 Exhibition Only	0-1
2 Berger Picard	0-1-0-1
4 Belgian Shepherd Dog	1-2-1-0
1 Beauceron	0-0-0-1
6 Bearded Collie	0-4-1-1
13 Australian Shepherd	2-5-3-3
1 Baby Puppy	0-1
1 Australian Cattle Dog	1-0-0-0

Judging Location:

TBL

TBL/RMP

RMP

RMP/GND

GND

JUDGING SCHEDULE - Alberta Kennel Club [SUMMER CLASSIC]

Conformation - Friday, August 04, 2023

Ring 4
LTD THEME SHOW
Group 2 (Scenthounds)
Aramis "Joy" Lim

1:00p.m.

2	Basset Hound	0-0-1-1
17	Beagle	2-7-4-4
1	Veteran	0-1
14	Dachshund (MLH)	3-5-3-3
2	Baby Puppy	1-1
1	Veteran	1-0
1	Dachshund (MS)	0-1-0-0
1	Veteran	1-0
2	Dachshund (MWH)	1-1-0-0
1	Dachshund (SLH)	0-0-0-1
1	Baby Puppy	1-0
3	Dachshund (SWH)	0-2-0-1
1	Bloodhound	1-0-0-0
0	Norwegian Elkhound	0-0-0-0
1	Baby Puppy	0-1
1	Otterhound	0-0-1-0

Ring 5
Group 5 (Toys)
John Burgess

8:15a.m.

8	Pug	1-4-2-1
1	Miniature Pinscher	0-0-1-0
3	Italian Greyhound	2-0-0-1
1	Baby Puppy	0-1
1	Griffon (Brussels)	0-0-1-0
3	English Toy Spaniel	2-0-0-1
1	Exhibition Only	1-0
3	Japanese Chin	0-3-0-0
11	Cavalier King Charles Sp.	1-5-3-2
1	Baby Puppy	0-1
1	Veteran	0-1

Ring 5
Group 5 (Toys)
John Burgess

1:15p.m.

4	Chihuahua (Long-Coat)	2-1-1-0
3	Chihuahua (Short-Coat)	1-0-0-2
24	Chinese Crested	9-5-5-5
3	Coton de Tulear	0-0-1-2
4	Havanese	2-1-0-1
1	Exhibition Only	0-1
2	Baby Puppy	2-0
14	Papillon	3-5-4-2
1	Exhibition Only	0-1
3	Baby Puppy	3-0
7	Pomeranian	0-5-1-1
3	Poodle (Toy)	0-2-1-0
2	Baby Puppy	2-0
1	Silky Terrier	0-0-1-0

Ring 5
Group 4 (Terriers)
Brian Reid

9:45a.m.

1	Norwich Terrier	0-0-1-0
1	Fox Terrier (Wire)	0-0-1-0
1	Fox Terrier (Smooth)	0-0-1-0
1	Baby Puppy	0-1
8	Cairn Terrier	1-4-1-2
1	Baby Puppy	0-1
30	Border Terrier	4-11-6-9
1	Exhibition Only	0-1
7	Scottish Terrier	0-2-4-1
5	Rat Terrier	1-3-0-1

Ring 6
Group 3 (Working Dogs)
Lois Wilson

8:00a.m.

2	Bullmastiff	1-0-1-0
1	Mastiff	1-0-0-0
2	Dogue de Bordeaux	0-1-1-0
12	Boxer	3-7-1-1

2	Baby Puppy	1-1
1	Veteran	0-1
1	Cane Corso	0-0-1-0
16	Rottweiler	3-7-5-1
1	Akita	0-0-0-1
3	Alaskan Malamute	1-1-0-1
14	Bernese Mountain Dog	2-6-3-3
1	Baby Puppy	0-1
18	Doberman Pinscher	2-6-3-7
1	Exhibition Only	1-0
2	Baby Puppy	0-2
1	Veteran	0-1
4	Siberian Husky	0-2-1-1
5	Schnauzer (Giant)	1-1-1-2
1	Veteran	0-1
11	Samoyed	2-1-3-5
1	Veteran	1-0

Ring 6
Group 3 (Working Dogs)
Lois Wilson

1:00p.m.

9	Portuguese Water Dog	0-3-5-1
36	Great Dane	7-14-4-11
1	Veteran	0-1
2	Baby Puppy	2-0

Ring 7
Group 6 (Non-Sporting Dogs)
Dana Cline

1:30p.m.

9	Poodle (Standard)	1-2-4-2
---	-------------------	---------

Ring 8
6:00p.m.

BEST IN SHOW JUDGE
 JOHN BURGESS

Order of Judging: Best Baby in Show, Best in Show and Best Puppy in Show

SPECIALTY SCHEDULES LISTED IN THE AKC JUDGING SCHEDULE ARE UNOFFICIAL – PLEASE SEE OFFICIAL SPECIALTY JUDGING SCHEDULES FOR COMPLETE INFORMATION.

Ring 9
8:35a.m.

WIRE-HAIRED POINTING GRIFFON CLUB OF CANADA - JUDGE DANA CLINE - 13 DOGS

Ring 9
3:30p.m.

IBIZAN HOUND CLUB OF CANADA - JUDGE JOHN PALMER - 10 DOGS

Ring 10
9:40a.m.

PEMBROKE CORGI ASSOCIATION - JUDGE JOHN BURGESS - 15 DOGS

Ring 10
11:30a.m.

BRITTANY SPANIEL CLUB OF CANADA SWEEPSTAKES - 6 DOGS

Ring 10
1:00p.m.

BRITTANY SPANIEL CLUB OF CANADA - JUDGE JOHN PALMER - 45 DOGS

Judging Location:

TBL

TBL/RMP

RMP

RMP/GND

GND

JUDGING SCHEDULE - Alberta Kennel Club [SUMMER CLASSIC]

Conformation - Friday, August 04, 2023

Ring 10
4:00p.m.

SCHIPPERKE CLUB OF CANADA
SWEEPSTAKES - 9 DOGS

Ring 11
10:30a.m.

SHIBA INU CANADA - JUDGE JOHN
BURGESS - 31 DOGS

Ring 11
2:00p.m.

BORZOI CANADA - JUDGE DANA
CLINE - 23 DOGS

Ring 12
10:00a.m.

PRAIRIE LABRADOR RETRIEVER
CLUB SWEEPSTAKES - 4 DOGS

Ring 12
Immediately Following Sweepstakes

PRAIRIE LABRADOR RETRIEVER
CLUB SPECIALTY - JUDGE VAL
WALTERS - 25 DOGS

Ring 14
8:30a.m.

GREAT DANE CLUB OF CANADA
SWEEPSTAKES - 13 DOGS

Ring 14
9:20a.m.

GREAT DANE CLUB OF CANADA -
JUDGE DANA CLINE - 64 DOGS

Ring 14
4:00p.m.

DALMATIAN CLUB OF WESTERN
CANADA - JUDGE RUI ALBERTA
OLIVIERA - 27 DOGS

Ring 15
8:00a.m.

ALL TERRIER CLUB OF ALBERTA
SWEEPSTAKES - 16 DOGS

Ring 15
8:45a.m.

ALL TERRIER CLUB OF ALBERTA -
JUDGE CINDY VOGELS - 124 DOGS

Ring 15
4:00p.m.

WESTWINDS SPORTING DOG CLUB
SWEEPSTAKES - 33 DOGS

Summary

Group 1 (Sporting Dogs)
123 Dogs, 7 Baby Puppy, 6 Veteran

Group 2 (Hounds)
94 Dogs, 3 Baby Puppy, 2 Veteran

Group 2 LTD Theme Show (Scenthounds)
42 Dogs, 4 Baby Puppy, 3 Veteran

Group 3 (Working Dogs)
135 Dogs, 7 Baby Puppy, 5 Veteran

Group 4 (Terriers)
99 Dogs, 5 Baby Puppy

Group 5 (Toys)
93 Dogs, 9 Baby Puppy, 1 Veteran

Group 6 (Non-Sporting Dogs)
119 Dogs, 6 Baby Puppy, 3 Veteran

Group 7 (Herding Dogs)
89 Dogs, 2 Baby Puppy, 4 Veteran

Total
794 Dogs, 43 Baby Puppy, 24 Veteran

- All Adult Group judging and Best in Show judging will be held in Ring # 8, Best Puppy in Group and Best Puppy in Show will be in Ring #7 on the North American field. This will follow the final breed being judged for that group.

Judging Location:

TBL

TBL/RMP

RMP

RMP/GND

GND

JUDGING SCHEDULE - Alberta Kennel Club [SUMMER CLASSIC]

Conformation - Saturday, August 05, 2023

Ring 1

Group 6 (Non-Sporting Dogs) Irene Latchford

9:00a.m.

9	Schipperke	3-4-2-0
1	Veteran	1-0

Ring 1

Group 7 (Herding Dogs) Irene Latchford

9:25a.m.

4	Welsh Corgi (Cardigan)	1-0-2-1
6	Welsh Corgi (Pembroke)	2-0-0-4
4	Mini American Shepherd	1-3-0-0
1	Veteran	1-0
1	Australian Cattle Dog	1-0-0-0
5	Border Collie	3-0-0-2
1	Beauceron	0-0-0-1
1	Iceland Sheepdog	0-1-0-0
1	Schapendoes	0-0-1-0

Ring 1

Group 6 (Non-Sporting Dogs) Irene Latchford

10:25a.m.

16	Shiba Inu	2-5-2-7
1	Baby Puppy	1-0
21	Keeshond	3-7-7-4
2	Veteran	1-1

Ring 1

Group 7 (Herding Dogs) Irene Latchford

1:00p.m.

16	Australian Shepherd	3-5-5-3
1	Baby Puppy	0-1
6	Bearded Collie	0-4-1-1
6	Belgian Shepherd Dog	2-2-1-1
2	Berger Picard	0-1-0-1
2	Bouvier des Flandres	1-1-0-0

3	Collie (Rough)	0-1-1-1
3	Collie (Smooth)	0-2-1-0
1	Finnish Lapphund	0-0-1-0
5	German Shepherd Dog	2-2-1-0
1	Baby Puppy	0-1
3	Old English Sheepdog	0-2-1-0
2	Veteran	1-2
30	Shetland Sheepdog	11-11-6-2
2	Veteran	2-1

Ring 2

Group 2 (Hounds) Cindy Vogels

8:00a.m.

15	Beagle	3-5-3-4
----	--------	---------

Ring 2

Group 1 (Sporting Dogs) Cindy Vogels

8:40a.m.

10	Weimaraner	1-4-3-2
3	Vizsla (Smooth-Haired)	2-1-0-0
1	Spaniel (Welsh Springer)	1-0-0-0
1	Spaniel (Irish Water)	0-0-0-1
10	Spaniel (Brittany)	4-2-3-1
2	Veteran	1-1
7	Setter (Irish)	1-1-2-3
1	Exhibition Only	1-0
5	Setter (English)	2-1-0-2
3	Spaniel (English Springer)	1-0-0-2
1	Spaniel (Clumber)	0-0-1-0
2	Spaniel (Am Cocker)	0-2-0-0
3	Spaniel (English Cocker)	1-1-1-0

Ring 2

Group 2 (Hounds) Cindy Vogels

10:35a.m.

1	Basset Hound	0-0-1-0
1	Exhibition Only	0-1
6	Whippet	0-1-2-3

1	Azawakh	1-0-0-0
1	Bloodhound	1-0-0-0
1	Deerhound (Scottish)	0-0-1-0
2	Greyhound	0-0-0-2
2	Ibizan Hound	0-1-1-0
2	Veteran	1-1
11	Irish Wolfhound	2-7-1-1
2	Otterhound	1-0-1-0
6	Rhodesian Ridgeback	3-1-0-2

Ring 2

Group 2 (Hounds) Cindy Vogels

1:00p.m.

7	Afghan Hound	3-2-0-2
1	Exhibition Only	0-1
10	Borzoi	3-3-1-3
1	Veteran	0-1
16	Dachshund (MLH)	4-6-3-3
2	Baby Puppy	1-1
1	Veteran	1-0
3	Dachshund (MS)	0-3-0-0
1	Veteran	1-0
3	Dachshund (MWH)	2-1-0-0
2	Dachshund (SLH)	0-0-1-1
1	Baby Puppy	1-0
1	Dachshund (SS)	0-0-0-1
8	Dachshund (SWH)	2-4-1-1
2	Finnish Spitz	0-0-0-2
1	Norwegian Elkhound	0-1-0-0
1	Baby Puppy	0-1
1	Saluki	0-0-0-1

Ring 3

Group 6 LTD SHOW (Non-Sporting Dogs) John Palmer

8:00a.m.

7	Bulldog	2-3-1-1
4	Baby Puppy	1-3
3	Chow Chow	1-1-1-0
1	Baby Puppy	0-1

22	Keeshond	3-6-8-5
4	Veteran	2-2
2	Boston Terrier	1-0-1-0
1	Baby Puppy	1-0
2	Bichon Frise	0-1-1-0
1	Tibetan Spaniel	0-0-1-0
1	Tibetan Terrier	1-0-0-0
1	Lhasa Apso	0-0-1-0
1	Veteran	1-0
4	Shih Tzu	1-2-1-0

Ring 3

Group 1 (Sporting Dogs) John Palmer

10:10a.m.

9	Griffon (WHP)	2-1-2-4
1	Baby Puppy	0-1
6	Pointer	0-3-2-1
1	Veteran	0-1
4	Retriever (CB)	0-3-1-0
1	Veteran	1-0
1	Retriever (Flat)	0-0-1-0
9	Retriever (NSDT)	4-3-1-1

Ring 3

Group 6 LTD SHOW (Non-Sporting Dogs) John Palmer

1:10p.m.

1	Xoloitzcuintli (Standard)	0-0-0-1
3	Poodle (Miniature)	1-1-0-1
3	Schipperke	1-1-1-0
20	Shiba Inu	3-6-2-9
1	Baby Puppy	1-0
3	Veteran	1-2

Judging Location:

TBL

TBL/RMP

RMP

RMP/GND

GND

JUDGING SCHEDULE - Alberta Kennel Club [SUMMER CLASSIC]

Conformation - Saturday, August 05, 2023

Ring 3

Group 6 LTD SHOW (Non-Sporting Dogs)

John Palmer

3:05p.m.

14 Dalmatian	1-1-4-8
1 Baby Puppy	0-1
1 Veteran	1-0
7 Poodle (Standard)	1-2-2-2
27 French Bulldog	8-9-3-7
1 Baby Puppy	1-0

118 Dogs, 9 Baby Puppy, 9 Veteran

*** Group Judging To Follow Last Breed ***

Ring 4

Group 6 (Non-Sporting Dogs)

Lois Wilson

8:00a.m.

3 Boston Terrier	1-1-1-0
1 Baby Puppy	1-0
1 Tibetan Spaniel	0-0-1-0
1 Tibetan Terrier	1-0-0-0
18 Dalmatian	1-3-5-9
2 Baby Puppy	0-2
1 Veteran	0-1
1 Lhasa Apso	0-0-1-0
1 Veteran	1-0
4 Shih Tzu	1-2-1-0
7 Bulldog	2-3-1-1
4 Baby Puppy	1-3
3 Chow Chow	1-1-1-0
1 Baby Puppy	0-1
3 Xoloitzcuintli (Standard)	1-0-0-2
3 Poodle (Miniature)	1-1-0-1

Ring 4

Group 5 (Toys)

Michael Canalizo

10:10a.m.

3 Chihuahua (Short-Coat)	1-0-0-2
4 Chihuahua (Long-Coat)	2-1-1-0

7 Pug	1-3-2-1
1 Griffon (Brussels)	0-0-1-0
3 Japanese Chin	0-3-0-0
3 English Toy Spaniel	2-0-0-1
1 Exhibition Only	1-0
11 Cavalier King Charles Sp.	1-6-2-2
1 Baby Puppy	0-1
1 Veteran	0-1
6 Havanese	3-2-0-1
1 Exhibition Only	0-1
3 Baby Puppy	2-1
4 Italian Greyhound	3-0-0-1
1 Baby Puppy	0-1

Ring 4

Group 5 (Toys)

Michael Canalizo

1:05p.m.

1 Miniature Pinscher	0-0-1-0
15 Papillon	3-6-4-2
1 Exhibition Only	0-1
3 Baby Puppy	3-0
1 Veteran	0-1
3 Coton de Tulear	0-0-1-2
1 Veteran	1-0
11 Pomeranian	4-5-1-1
4 Poodle (Toy)	1-2-1-0
2 Baby Puppy	2-0
1 Veteran	1-0
1 Silky Terrier	0-0-1-0

Ring 4

Group 5 (Toys)

Michael Canalizo

3:35p.m.

24 Chinese Crested	8-4-7-5
1 Veteran	1-0

Ring 5

Group 4 (Terriers)

John Burgess

8:00a.m.

14 Staffordshire Bull Terrier	4-5-2-3
2 Baby Puppy	1-1
2 Bull Terrier (Miniature)	0-0-1-1
5 Rat Terrier	1-3-0-1
32 Border Terrier	4-11-7-10
1 Exhibition Only	0-1
5 Parson Russell Terrier	3-2-0-0
1 Veteran	1-0
1 Fox Terrier (Smooth)	0-0-1-0
1 Baby Puppy	0-1
1 Fox Terrier (Wire)	0-0-1-0
9 Cairn Terrier	1-5-1-2
1 Baby Puppy	0-1
1 Norwich Terrier	0-0-1-0
2 Schnauzer (Miniature)	1-1-0-0
7 Scottish Terrier	0-2-4-1
2 Skye Terrier	0-1-1-0
7 West Highland White Terr.	1-5-0-1
2 Baby Puppy	0-2
1 Irish Terrier	0-1-0-0
2 Kerry Blue Terrier	1-0-0-1
1 Exhibition Only	0-1
3 Soft-Coated Wheaten	0-1-1-1

Ring 5

Group 6 (Non-Sporting Dogs)

Lois Wilson

1:00p.m.

27 French Bulldog	8-11-3-5
2 Bichon Frise	0-1-1-0
8 Poodle (Standard)	1-2-3-2

Ring 6

Group 3 (Working Dogs)

Rui Alberto Oliveira

8:15a.m.

14 Boxer	5-7-1-1
1 Veteran	1-0

36 Great Dane	7-14-6-9
2 Baby Puppy	2-0
1 Veteran	0-1
2 Bullmastiff	1-0-1-0
1 Cane Corso	0-0-1-0
2 Dogue de Bordeaux	0-1-1-0
1 Mastiff	1-0-0-0
15 Bernese Mountain Dog	2-6-4-3
1 Baby Puppy	0-1
1 Akita	0-0-0-1
2 Alaskan Malamute	1-0-0-1

Ring 6

Group 3 (Working Dogs)

Rui Alberto Oliveira

1:00p.m.

4 Siberian Husky	0-2-1-1
1 Schnauzer (Standard)	1-0-0-0
6 Schnauzer (Giant)	2-1-1-2
1 Veteran	0-1
13 Samoyed	2-2-4-5
1 Veteran	1-0
2 Saint Bernard	0-2-0-0
17 Rottweiler	3-8-5-1
10 Portuguese Water Dog	0-3-6-1
18 Doberman Pinscher	3-5-3-7
2 Exhibition Only	1-1
2 Baby Puppy	0-2
2 Veteran	1-1

Ring 7

Group 1 (Sporting Dogs)

Aramis "Joy" Lim

8:00a.m.

18 Pointer (GSH)	2-8-6-2
3 Baby Puppy	0-3
3 Veteran	3-0
14 Retriever (Lab)	1-6-2-5
21 Retriever (Golden)	10-8-3-0
1 Exhibition Only	1-0
4 Baby Puppy	1-3

Judging Location:

TBL

TBL/RMP

RMP

RMP/GND

GND

JUDGING SCHEDULE - Alberta Kennel Club [SUMMER CLASSIC]

Conformation - Saturday, August 05, 2023

Ring 7
Group 4 (Terriers)
John Burgess

1:00p.m.

1 Bull Terrier 0-0-1-0
7 Am Staffordshire 1-1-2-3

Ring 8
6:00p.m.

BEST IN SHOW
JUDGE MICHAEL CANALIZO
ORDER OF JUDGING:

Order of Judging: Best Baby in Show, Best in Show and Best Puppy in Show

SPECIALTY SCHEDULES LISTED IN THE AKC JUDGING SCHEDULE ARE UNOFFICIAL – PLEASE SEE OFFICIAL SPECIALTY JUDGING SCHEDULES FOR COMPLETE INFORMATION.

Ring 9
10:00a.m.

ALBERTA BOXER CLUB
SWEEPSTAKES - 9 DOGS

Ring 9
10:35a.m.

ALBERTA BOXER CLUB - JUDGE
ARAMIS LIM - 20 DOGS

Ring 9
1:00p.m.

BEAGLE CLUB OF WESTERN

CANADA - JUDGE BARBARA CAROL
SCHERER - 29 DOGS

Ring 10
10:30a.m.

SCHIPPERKE CLUB OF CANADA -
JUDGE LOIS WILSON - 28 DOGS

Ring 10
12:30p.m.

BORDER TERRIER CANADA
SWEEPSTAKES - 8 DOGS

Ring 10
2:15p.m.

BORDER TERRIER CANADA - JUDGE
AMANDA POUGH - 59 DOGS

Ring 11
8:00a.m.

FRENCH BULLDOG FANCIERS OF
CANADA SWEEPSTAKES - 14 DOGS

Ring 11
8:45a.m.

FRENCH BULLDOG FANCIERS OF
CANADA - JUDGE STEVE REALE - 43
DOGS

Ring 11
11:30a.m.

AMERICAN STAFFORDSHIRE
TERRIER CLUB SWEEPSTAKES - 3

DOGS

Ring 11
11:40a.m.

AMERICAN STAFFORDSHIRE
TERRIER CLUB - JUDGE ARAMIS LIM
- 11 DOGS

Ring 11
3:40p.m.

CAIRN TERRIER CLUB OF CANADA -
JUDGE DANA CLINE - 17 DOGS

Ring 12
8:30a.m.

SOUTHERN ALBERTA TOY DOG
FANCIERS - JUDGE DANA CLINE -
127 DOGS

Ring 14
9:00a.m.

ALBERTA DOBERMAN PINSCHER
CLUB - JUDGE DOUG JENSEN - 50
DOGS

Ring 14
1:10p.m.

GREAT DANE CLUB OF CANADA -
JUDGE ARAMIS LIM - 56 DOGS

Ring 15
8:30a.m.

WESTWINDS SPORTING DOG CLUB

SPECIALTY
JUDGE WENDY HAMILTON-PETKAU
POINTERS ONLY

MARJORIE MARTORELLA BALANCE
OF BREEDS - 156 DOGS

Summary

Group 1 (Sporting Dogs)
128 Dogs, 8 Baby Puppy, 7 Veteran

Group 2 (Hounds)
102 Dogs, 4 Baby Puppy, 5 Veteran

Group 3 (Working Dogs)
145 Dogs, 5 Baby Puppy, 6 Veteran

Group 4 (Terriers)
102 Dogs, 6 Baby Puppy, 1 Veteran

Group 5 (Toys)
101 Dogs, 10 Baby Puppy, 5 Veteran

Group 6 (Non-Sporting Dogs)
127 Dogs, 9 Baby Puppy, 5 Veteran

Group 6 LTD SHOW (Non-Sporting Dogs)
118 Dogs, 9 Baby Puppy, 9 Veteran

Group 7 (Herding Dogs)
100 Dogs, 2 Baby Puppy, 5 Veteran

Total
923 Dogs, 53 Baby Puppy, 43 Veteran

- All Adult Group judging and Best in Show judging will be held in Ring # 8, Best Puppy in Group and Best Puppy in Show will be in Ring #7 on the North American field. This will follow the final breed being judged for that group.

Judging Location:

TBL

TBL/RMP

RMP

RMP/GND

GND

JUDGING SCHEDULE - Alberta Kennel Club [SUMMER CLASSIC]

Conformation - Sunday, August 06, 2023

Ring 1

Group 3 LTD SHOW

(Working Dogs)

Dana Cline

8:40a.m.

16 Rottweiler	3-7-5-1
3 Alaskan Malamute	1-1-0-1
1 Veteran	1-0
1 Akita	0-0-0-1
14 Boxer	5-7-1-1
2 Baby Puppy	1-1
2 Veteran	1-1
2 Bullmastiff	1-0-1-0
1 Dogue de Bordeaux	0-1-0-0
1 Cane Corso	0-0-1-0
8 Portuguese Water Dog	0-2-5-1
2 Saint Bernard	0-2-0-0
15 Bernese Mountain Dog	2-6-4-3
1 Baby Puppy	0-1

Ring 1

Group 3 LTD SHOW

(Working Dogs)

Dana Cline

1:00p.m.

23 Doberman Pinscher	4-4-5-10
1 Baby Puppy	0-1
2 Veteran	1-1
14 Samoyed	2-2-5-5
1 Veteran	1-0
6 Schnauzer (Giant)	2-1-1-2
1 Veteran	0-1
4 Siberian Husky	0-2-1-1

110 Dogs, 4 Baby Puppy, 7 Veteran

*** Group Judging To Follow Last Breed ***

Ring 2

Group 6 (Non-Sporting Dogs)

Aramis "Joy" Lim

8:00a.m.

17 Shiba Inu	2-5-2-8
6 Boston Terrier	3-1-1-1

8 Bulldog	2-4-1-1
3 Baby Puppy	1-2
3 Chow Chow	1-1-1-0
1 Baby Puppy	0-1
19 Keeshond	3-7-5-4
2 Veteran	1-1
1 Lhasa Apso	0-0-1-0
1 Veteran	1-0
1 Shih Tzu	0-0-1-0
16 Schipperke	4-7-3-2
1 Veteran	1-0
4 Poodle (Miniature)	2-1-0-1
18 Dalmatian	1-3-4-10
1 Baby Puppy	0-1

Ring 2

Group 6 (Non-Sporting Dogs)

Aramis "Joy" Lim

1:00p.m.

1 Bichon Frise	0-0-1-0
1 Tibetan Terrier	1-0-0-0
3 Xoloitzcuintli (Standard)	1-0-0-2
8 Poodle (Standard)	1-2-3-2

Ring 3

Group 3 (Working Dogs)

Marjorie Martorella

8:00a.m.

14 Boxer	5-7-1-1
1 Mastiff	1-0-0-0
2 Bullmastiff	1-0-1-0
2 Dogue de Bordeaux	0-1-1-0
1 Cane Corso	0-0-1-0
15 Bernese Mountain Dog	2-6-4-3
1 Baby Puppy	0-1
28 Great Dane	7-10-3-8
2 Baby Puppy	2-0
1 Akita	0-0-0-1
4 Alaskan Malamute	1-2-0-1
19 Doberman Pinscher	3-6-3-7
1 Exhibition Only	1-0
1 Baby Puppy	0-1
2 Veteran	1-1

Ring 3

Group 1 (Sporting Dogs)

John Burgess

1:00p.m.

21 Retriever (Golden)	10-8-3-0
4 Baby Puppy	1-3
11 Retriever (Lab)	2-4-2-3
9 Retriever (NSDT)	4-3-1-1
6 Setter (English)	3-1-0-2
7 Setter (Irish)	1-1-2-3
2 Spaniel (Am Cocker)	0-2-0-0
3 Spaniel (English Cocker)	1-1-1-0

Ring 4

Group 2 (Hounds)

Murray Eason

8:00a.m.

2 Basset Hound	0-0-1-1
7 Whippet	0-1-2-4
1 Veteran	1-0
1 Bloodhound	1-0-0-0
1 Azawakh	1-0-0-0
6 Rhodesian Ridgeback	3-1-0-2
2 Ibizan Hound	0-1-1-0
1 Greyhound	0-0-0-1
1 Saluki	0-0-0-1
2 Otterhound	1-0-1-0
1 Norwegian Elkhound	0-1-0-0
1 Baby Puppy	0-1
2 Finnish Spitz	0-0-0-2
1 Deerhound (Scottish)	0-0-1-0
6 Borzoi	1-3-1-1
1 Exhibition Only	1-0
5 Afghan Hound	2-2-0-1
1 Exhibition Only	0-1
8 Dachshund (SWH)	2-4-1-1
1 Dachshund (SS)	0-0-0-1
2 Dachshund (SLH)	0-0-1-1
1 Baby Puppy	1-0
3 Dachshund (MWH)	2-1-0-0
3 Dachshund (MS)	0-3-0-0
1 Veteran	1-0
14 Dachshund (MLH)	3-5-3-3

1 Baby Puppy	0-1
1 Veteran	1-0
14 Beagle	3-5-3-3
4 Basenji	1-0-1-2
9 Irish Wolfhound	2-5-0-2

Ring 4

Group 7 (Herding Dogs)

John Palmer

1:30p.m.

1 Australian Cattle Dog	1-0-0-0
16 Australian Shepherd	3-5-5-3
6 Bearded Collie	0-4-1-1
1 Beauceron	0-0-0-1
5 Belgian Shepherd Dog	2-2-1-0
1 Berger Picard	0-0-0-1
4 Border Collie	2-0-0-2
2 Bouvier des Flandres	1-1-0-0
3 Collie (Rough)	0-1-1-1
3 Collie (Smooth)	0-2-1-0
1 Finnish Lapphund	0-0-1-0
5 German Shepherd Dog	2-2-1-0
1 Baby Puppy	0-1
1 Iceland Sheepdog	0-1-0-0
3 Old English Sheepdog	0-2-1-0
2 Veteran	0-2
1 Schapendoes	0-0-1-0
4 Mini American Shepherd	1-3-0-0
1 Veteran	1-0
4 Welsh Corgi (Cardigan)	1-0-2-1
4 Welsh Corgi (Pembroke)	1-0-0-3

Ring 5

Group 5 (Toys)

Lois Wilson

9:00a.m.

8 Pug	1-4-2-1
-------	---------

Judging Location:

TBL

TBL/RMP

RMP

RMP/GND

GND

JUDGING SCHEDULE - Alberta Kennel Club [SUMMER CLASSIC]

Conformation - Sunday, August 06, 2023

Ring 5
Group 6 (Non-Sporting Dogs)
Rui Alberto Oliveira

9:30a.m.

30 French Bulldog	8-12-4-6
1 Baby Puppy	1-1
1 Veteran	2-0

Ring 5
Group 4 (Terriers)
Rui Alberto Oliveira

11:00a.m.

11 Cairn Terrier	2-5-1-3
1 Fox Terrier (Smooth)	0-0-1-0
1 Baby Puppy	0-1
1 Fox Terrier (Wire)	0-0-1-0
1 Norwich Terrier	0-0-1-0
6 Parson Russell Terrier	3-2-0-1
4 Rat Terrier	0-3-0-1

Ring 5
Group 4 (Terriers)
Rui Alberto Oliveira

1:20p.m.

6 Am Staffordshire	1-1-1-3
1 Bull Terrier	0-0-1-0
33 Border Terrier	5-11-7-10
2 Exhibition Only	0-2
2 Schnauzer (Miniature)	1-1-0-0
7 Scottish Terrier	0-2-4-1
2 Skye Terrier	0-1-1-0
8 West Highland White Terr.	1-6-0-1
1 Baby Puppy	0-1
2 Bull Terrier (Miniature)	0-0-1-1
1 Irish Terrier	0-1-0-0
2 Kerry Blue Terrier	1-0-0-1
1 Exhibition Only	0-1
2 Soft-Coated Wheaten	0-1-1-0
13 Staffordshire Bull Terrier	4-5-2-2
1 Exhibition Only	0-1
2 Baby Puppy	1-1

Ring 6
Group 5 (Toys)
Irene Latchford

8:20a.m.

3 English Toy Spaniel	2-0-0-1
1 Exhibition Only	1-0
1 Griffon (Brussels)	0-0-1-0
2 Italian Greyhound	2-0-0-0
3 Japanese Chin	0-3-0-0
1 Miniature Pinscher	0-0-1-0
3 Chihuahua (Short-Coat)	1-0-0-2
4 Chihuahua (Long-Coat)	2-1-1-0

Ring 6
Group 5 (Toys)
Irene Latchford

11:05a.m.

9 Cavalier King Charles Sp.	1-6-1-1
1 Baby Puppy	0-1
1 Veteran	0-1
3 Coton de Tulear	0-0-1-2
1 Veteran	1-0
6 Havanese	3-2-0-1
1 Exhibition Only	0-1
1 Baby Puppy	1-0

Ring 6
Group 3 LTD SHOW (Working Dogs)
Irene Latchford

1:00p.m.

26 Great Dane	6-7-5-8
2 Baby Puppy	2-0

Ring 6
Group 5 (Toys)
Irene Latchford

2:10p.m.

24 Chinese Crested	9-5-6-4
14 Papillon	3-5-4-2
1 Exhibition Only	0-1
4 Baby Puppy	2-2

Ring 6
Group 3 (Working Dogs)
Irene Latchford

9:00a.m.

9 Portuguese Water Dog	0-3-5-1
2 Saint Bernard	0-2-0-0
13 Samoyed	2-2-4-5
1 Veteran	1-0
4 Siberian Husky	0-2-1-1
6 Schnauzer (Giant)	2-1-1-2
1 Veteran	0-1
14 Rottweiler	3-6-4-1
1 Exhibition Only	0-1

Ring 7
Group 7 (Herding Dogs)
John Palmer

10:35a.m.

31 Shetland Sheepdog	11-11-7-2
1 Exhibition Only	1-0
4 Veteran	1-3

Ring 7
Group 5 (Toys)
Lois Wilson

1:10p.m.

8 Pomeranian	1-5-1-1
1 Baby Puppy	0-1
4 Poodle (Toy)	1-2-1-0
2 Baby Puppy	2-0
1 Veteran	1-0
1 Silky Terrier	0-0-1-0

Ring 9
Group 1 (Sporting Dogs)
John Burgess

9:00a.m.

10 Weimaraner	1-4-3-2
3 Vizsla (Smooth-Haired)	2-1-0-0
16 Pointer (GSH)	2-8-3-3
2 Veteran	2-0

7 Pointer	0-3-3-1
1 Veteran	0-1
1 Spaniel (Welsh Springer)	1-0-0-0
1 Spaniel (Irish Water)	0-0-0-1
11 Spaniel (Brittany)	4-2-4-1
2 Veteran	1-1
2 Retriever (Flat)	0-0-2-0
4 Retriever (CB)	0-3-1-0
1 Veteran	1-0
8 Griffon (WHP)	2-1-2-3
1 Baby Puppy	0-1
2 Spaniel (English Springer)	1-0-0-1
2 Baby Puppy	1-1
1 Spaniel (Clumber)	0-0-1-0

Ring 8
6:00p.m.

BEST IN SHOW
JUDGE RUI ALBERTO OLIVEIRA

Order of Judging: Best Baby in Show, Best in Show and Best Puppy in Show

SPECIALTY SCHEDULES LISTED IN THE AKC JUDGING SCHEDULE ARE UNOFFICIAL – PLEASE SEE OFFICIAL SPECIALTY JUDGING SCHEDULES FOR COMPLETE INFORMATION.

Ring 9
2:30p.m.

BEAGLE CLUB OF CANADA
SWEEPSTAKES - 9 DOGS

Ring 9
3:45p.m.

BEAGLE CLUB OF CANADA - JUDGE
DANA CLINE - 31 DOGS

Judging Location:

TBL

TBL/RMP

RMP

RMP/GND

GND

JUDGING SCHEDULE - Alberta Kennel Club [SUMMER CLASSIC]

Conformation - Sunday, August 06, 2023

Ring 10
9:30a.m.

AMERICAN STAFFORDSHIRE
TERRIER CLUB SWEEPSTAKES - 3
DOGS

Ring 10
9:45a.m.

AMERICAN STAFFORDSHIRE
TERRIER CLUB - JUDGE LOIS
WILSON - 9 DOGS

Ring 10
11:30a.m.

KEESHOND CLUB OF CANADA
SWEEPSTAKES - 18 DOGS

Ring 10
2:15p.m.

KEESHOND CLUB OF CANADA -
JUDGE LOIS WILSON - 51 DOGS

Ring 11
10:00a.m.

SHIBA INU CANADA SWEEPSTAKES -
8 DOGS

Ring 11
10:30a.m.

SHIBA INU CANADA - JUDGE LOIS
WILSON - 31 DOGS

Ring 11
1:00p.m.

POINTER CLUB OF CANADA
SWEEPSTAKES - 4 DOGS

Ring 11
1:30p.m.

POINTER CLUB OF CANADA - JUDGE
MARJORIE MARTORELLA - 13 DOGS

Ring 12
8:30a.m.

STAFFORDSHIRE BULL TERRIER
CLUB OF CANADA - SWEEPSTAKES -
14 DOGS

Ring 12
9:30a.m.

STAFFORDSHIRE BULL TERRIER
CLUB OF CANADA - JUDGE DAWNE
DEELEY - 43 DOGS

Ring 12
1:15p.m.

CANADIAN SHETLAND SHEEPDOG
ASSOCIATION SWEEPSTAKES - 16
DOGS

Ring 12
2:10p.m.

CANADIAN SHETLAND SHEEPDOG
ASSOCIATION - JUDGE ARAMIS LIM -
41 DOGS

Ring 14
9:00a.m.

IRISH WOLFHOUND CLUB OF
CANADA - SWEEPSTAKES - 7 DOGS

Ring 14
9:30a.m.

IRISH WOLFHOUND CLUB OF
CANADA - JUDGE JOHN PALMER -
19 DOGS

Ring 14
11:30a.m.

CANADIAN SCOTTISH TERRIER
CLUB SWEEPSTAKES - 2 DOGS

Ring 14
11:35a.m.

CANADIAN SCOTTISH TERRIER
CLUB - JUDGE DANA CLINE - 8
DOGS

Ring 14
2:20p.m.

DALMATIAN CLUB OF CANADA -
SWEEPSTAKES - 7 DOGS

Ring 14
2:45p.m.

DALMATIAN CLUB OF CANADA -
JUDGE MARJORIE MARTORELLA -
31 DOGS

Ring 15
10:45a.m.

AFGHAN HOUND CLUB OF CANADA
SWEEPSTAKES - 2 DOGS

Ring 15
11:00a.m.

AFGHAN HOUND CLUB OF CANADA
- JUDGE LOU GUERRO - 12 DOGS

Ring 15
1:00p.m.

FOOTHILLS GAZEHOUD
SWEEPSTAKES - 16 DOGS

Ring 15
Immediately Following Sweepstakes

FOOTHILLS GAZEHOUD CLUB
SPECIALTY - JUDGE MICHAEL
CANALIZO - 89 DOGS

Summary

Group 1 (Sporting Dogs)
125 Dogs, 7 Baby Puppy, 6 Veteran

Group 2 (Hounds)
96 Dogs, 3 Baby Puppy, 3 Veteran

Group 3 (Working Dogs)
135 Dogs, 4 Baby Puppy, 4 Veteran

Group 3 LTD SHOW (Working Dogs)
136 Dogs, 6 Baby Puppy, 7 Veteran

Group 4 (Terriers)
103 Dogs, 4 Baby Puppy

Group 5 (Toys)
94 Dogs, 9 Baby Puppy, 3 Veteran

Group 6 (Non-Sporting Dogs)
136 Dogs, 6 Baby Puppy, 5 Veteran

Group 7 (Herding Dogs)
96 Dogs, 1 Baby Puppy, 7 Veteran

Total
920 Dogs, 40 Baby Puppy, 35 Veteran

- All Adult Group judging and Best in Show judging will be held in Ring # 8, Best Puppy in Group and Best Puppy in Show will be in Ring #7 on the North American field. This will follow the final breed being judged for that group.

Judging Location:

TBL

TBL/RMP

RMP

RMP/GND

GND

JUDGING SCHEDULE - Alberta Kennel Club [SUMMER CLASSIC]

Conformation - Monday, August 07, 2023

Ring 1
Group 6 (Non-Sporting Dogs)
Irene Latchford

8:25a.m.

25 French Bulldog	7-10-4-4
1 Baby Puppy	0-1
6 Boston Terrier	3-1-1-1
6 Bulldog	2-4-0-0
2 Chow Chow	1-0-1-0
1 Baby Puppy	0-1
14 Dalmatian	1-3-4-6
1 Baby Puppy	0-1
1 Veteran	0-1
6 Poodle (Standard)	1-1-2-2
2 Bichon Frise	0-1-1-0
2 Poodle (Miniature)	1-0-0-1

Ring 1
Group 2 (Hounds)
Irene Latchford

11:45a.m.

6 Borzoi	2-2-1-1
1 Bloodhound	1-0-0-0

Ring 1
Group 2 (Hounds)
Irene Latchford

1:00p.m.

1 Basset Hound	0-0-1-0
1 Exhibition Only	0-1
7 Whippet	0-1-2-4
1 Veteran	1-0
6 Rhodesian Ridgeback	3-1-0-2
2 Otterhound	1-0-1-0
1 Norwegian Elkhound	0-1-0-0
1 Baby Puppy	0-1
6 Irish Wolfhound	1-4-0-1
1 Ibizan Hound	0-0-1-0
1 Greyhound	0-0-0-1
2 Finnish Spitz	0-0-0-2
1 Deerhound (Scottish)	0-0-1-0
3 Afghan Hound	2-1-0-0

4 Dachshund (SWH)	0-3-0-1
1 Dachshund (SS)	0-0-0-1
2 Dachshund (SLH)	0-0-1-1
1 Baby Puppy	1-0
3 Dachshund (MWH)	2-1-0-0
2 Dachshund (MS)	0-2-0-0
12 Dachshund (MLH)	2-4-3-3
1 Baby Puppy	0-1
1 Veteran	1-0
9 Beagle	0-4-2-3

Ring 2
Group 7 (Herding Dogs)
Rui Alberto Oliveira

8:00a.m.

1 Australian Cattle Dog	1-0-0-0
14 Australian Shepherd	3-4-4-3
1 Beauceron	0-0-0-1
5 Belgian Shepherd Dog	2-2-1-0
1 Berger Picard	0-0-0-1
5 Border Collie	3-0-0-2
2 Bouvier des Flandres	1-1-0-0
1 Schapendoes	0-0-1-0
1 Finnish Lapphund	0-0-1-0
3 Collie (Smooth)	0-2-1-0
3 Collie (Rough)	0-1-1-1
4 German Shepherd Dog	1-2-1-0
1 Baby Puppy	0-1
2 Mini American Shepherd	0-2-0-0
4 Welsh Corgi (Cardigan)	1-0-2-1
4 Welsh Corgi (Pembroke)	1-0-0-3
30 Shetland Sheepdog	11-10-7-2
3 Veteran	1-2
5 Bearded Collie	0-3-1-1
3 Old English Sheepdog	0-2-1-0
2 Veteran	0-2

Ring 3
Group 6 (Non-Sporting Dogs)
Dana Cline

9:20a.m.

14 Shiba Inu	1-6-2-5
2 Baby Puppy	1-1

Ring 3
Group 1 (Sporting Dogs)
Dana Cline

10:00a.m.

5 Spaniel (English Springer)	1-0-1-3
2 Baby Puppy	1-1
1 Spaniel (Clumber)	0-0-1-0
13 Retriever (Lab)	2-5-2-4
4 Retriever (CB)	0-3-1-0
1 Veteran	1-0
16 Pointer (GSH)	2-8-4-2
1 Veteran	1-0
6 Pointer	0-3-2-1
1 Veteran	0-1

Ring 3
Group 1 (Sporting Dogs)
Dana Cline

1:00p.m.

2 Spaniel (Am Cocker)	0-2-0-0
3 Spaniel (English Cocker)	1-1-1-0
2 Retriever (Flat)	0-0-2-0
21 Retriever (Golden)	10-7-4-0
3 Baby Puppy	1-2
9 Retriever (NSDT)	4-3-1-1
6 Setter (English)	3-1-0-2
2 Setter (Irish)	1-1-0-0
9 Spaniel (Brittany)	3-2-3-1
1 Veteran	1-0
1 Spaniel (Irish Water)	0-0-0-1
1 Spaniel (Welsh Springer)	1-0-0-0
3 Vizsla (Smooth-Haired)	2-1-0-0
8 Weimaraner	1-2-3-2
1 Veteran	0-1

Ring 4
Group 6 (Non-Sporting Dogs)
John Burgess

8:20a.m.

3 Xoloitzcuintli (Standard)	1-0-0-2
15 Schipperke	4-6-3-2
1 Veteran	1-0

17 Keeshond	3-6-4-4
2 Veteran	1-1
4 Shih Tzu	1-2-1-0

Ring 4
Group 7 LTD SHOW
(Herding Dogs)
John Burgess

10:00a.m.

1 Australian Cattle Dog	1-0-0-0
14 Australian Shepherd	3-4-4-3
2 Baby Puppy	0-2
1 Beauceron	0-0-0-1
5 Belgian Shepherd Dog	2-2-1-0
1 Berger Picard	0-0-0-1
4 Border Collie	2-0-0-2
1 Bouvier des Flandres	1-0-0-0
1 Schapendoes	0-0-1-0
1 Finnish Lapphund	0-0-1-0
3 Collie (Smooth)	0-2-1-0
4 Collie (Rough)	0-2-1-1
2 German Shepherd Dog	0-1-1-0
1 Baby Puppy	0-1

Ring 4
Group 7 LTD SHOW
(Herding Dogs)
John Burgess

1:00p.m.

5 Bearded Collie	0-3-1-1
3 Old English Sheepdog	0-2-1-0
2 Veteran	0-2
2 Mini American Shepherd	0-2-0-0
4 Welsh Corgi (Cardigan)	1-0-2-1
29 Shetland Sheepdog	11-9-7-2
3 Veteran	1-2

81 Dogs, 3 Baby Puppy, 5 Veteran

*** Group Judging To Follow Last Breed ***

Judging Location:

TBL

TBL/RMP

RMP

RMP/GND

GND

JUDGING SCHEDULE - Alberta Kennel Club [SUMMER CLASSIC]

Conformation - Monday, August 07, 2023

Ring 5
Group 3 (Working Dogs)
John Palmer

8:00a.m.

14 Boxer	5-7-1-1
16 Great Dane	4-4-1-7
2 Baby Puppy	2-0
1 Veteran	0-1

Ring 5
Group 4 (Terriers)
John Palmer

9:20a.m.

4 Am Staffordshire	0-1-1-2
--------------------	---------

Ring 5
Group 5 (Toys)
John Palmer

9:30a.m.

8 Pug	1-4-2-1
1 Griffon (Brussels)	0-0-1-0
3 English Toy Spaniel	2-0-0-1
1 Exhibition Only	1-0
3 Japanese Chin	0-3-0-0
8 Cavalier King Charles Sp.	1-4-1-2
1 Baby Puppy	0-1
1 Veteran	0-1
4 Chihuahua (Long-Coat)	2-1-1-0
3 Chihuahua (Short-Coat)	1-0-0-2
20 Chinese Crested	7-4-4-5
2 Italian Greyhound	2-0-0-0
1 Miniature Pinscher	0-0-1-0
4 Havanese	2-1-0-1
3 Baby Puppy	2-1
1 Silky Terrier	0-0-1-0

Ring 5
Group 5 (Toys)
John Palmer

1:00p.m.

2 Coton de Tulear	0-0-0-2
-------------------	---------

13 Papillon	3-4-4-2
1 Exhibition Only	0-1
3 Baby Puppy	2-1
11 Pomeranian	3-6-1-1
2 Poodle (Toy)	0-1-1-0
1 Baby Puppy	1-0

Ring 6
Group 3 (Working Dogs)
Aramis "Joy" Lim

8:40a.m.

15 Doberman Pinscher	1-4-3-7
1 Baby Puppy	0-1
1 Veteran	0-1
2 Bullmastiff	1-0-1-0
2 Dogue de Bordeaux	0-1-1-0
1 Mastiff	1-0-0-0
1 Cane Corso	0-0-1-0
16 Rottweiler	3-7-4-2
1 Akita	0-0-0-1
5 Alaskan Malamute	2-2-0-1
13 Bernese Mountain Dog	2-6-3-2
1 Baby Puppy	0-1
2 Saint Bernard	0-2-0-0
11 Samoyed	2-1-3-5
1 Veteran	1-0
5 Schnauzer (Giant)	1-1-1-2
1 Veteran	0-1
4 Siberian Husky	0-2-1-1

Ring 6
Group 3 (Working Dogs)
Aramis "Joy" Lim

1:00p.m.

8 Portuguese Water Dog	0-3-5-0
------------------------	---------

Ring 6
Group 7 LTD SHOW
(Herding Dogs)
Aramis "Joy" Lim

2:00p.m.

4 Welsh Corgi (Pembroke)	1-0-0-3
--------------------------	---------

Ring 6
Group 1 (Sporting Dogs)
Aramis "Joy" Lim

2:10p.m.

6 Griffon (WHP)	1-0-2-3
1 Baby Puppy	0-1

Ring 9
Group 4 (Terriers)
Lois Wilson

8:00a.m.

1 Bull Terrier	0-0-1-0
34 Border Terrier	5-11-7-11
8 Cairn Terrier	1-4-1-2
1 Fox Terrier (Smooth)	0-0-1-0
1 Baby Puppy	0-1
1 Fox Terrier (Wire)	0-0-1-0
1 Norwich Terrier	0-0-1-0
3 Parson Russell Terrier	2-1-0-0
2 Schnauzer (Miniature)	1-1-0-0
8 Scottish Terrier	0-3-4-1
2 Skye Terrier	0-1-1-0
4 West Highland White Terr.	0-3-0-1
2 Bull Terrier (Miniature)	0-0-1-1
1 Irish Terrier	0-1-0-0
2 Kerry Blue Terrier	1-0-0-1
1 Exhibition Only	0-1
2 Soft-Coated Wheaten	0-1-1-0
12 Staffordshire Bull Terrier	3-5-1-3
2 Baby Puppy	1-1

Ring 8
6:00p.m.

BEST IN SHOW
JUDGE DANA CLINE

Order of Judging: Best Baby in Show, Best in Show and Best Puppy in Show

Summary

Group 1 (Sporting Dogs)
118 Dogs, 6 Baby Puppy, 5 Veteran

Group 2 (Hounds)
71 Dogs, 3 Baby Puppy, 2 Veteran

Group 3 (Working Dogs)
116 Dogs, 4 Baby Puppy, 4 Veteran

Group 4 (Terriers)
88 Dogs, 3 Baby Puppy

Group 5 (Toys)
86 Dogs, 8 Baby Puppy, 1 Veteran

Group 6 (Non-Sporting Dogs)
116 Dogs, 5 Baby Puppy, 4 Veteran

Group 7 (Herding Dogs)
89 Dogs, 1 Baby Puppy, 5 Veteran

Group 7 LTD SHOW (Herding Dogs)
85 Dogs, 3 Baby Puppy, 5 Veteran

Total
769 Dogs, 33 Baby Puppy, 26 Veteran

- All Adult Group judging and Best in Show judging will be held in Ring # 8, Best Puppy in Group and Best Puppy in Show will be in Ring #7 on the North American field. This will follow the final breed being judged for that group.

Judging Location:

TBL

TBL/RMP

RMP

RMP/GND

GND

JUDGING SCHEDULE - Alberta Kennel Club [SUMMER CLASSIC]

Rally and Obedience Trials - Friday, August 04, 2023

The Obedience Schedule is based on 9 dogs per hour in Pre-Novice, 8 dogs per hour in Novice, 7 dogs per hour in Open and 6 dogs per hour in Utility.
The Rally O Schedule is based on 15 dogs per hour as well as 10 minutes to reset between Novice, Advanced, Excellent and Master and a 10-minute Walk Through.

Breaks will be at the judge's discretion

RALLY OBEDIENCE FRIDAY TRIAL #1

Ring 16 - Cheryl Bishop

10:00a.m.

Rally Master

1468, 1479, 1482, 1483, 1484, 1486, 1487, 1492, 1494,
1495, 1496, 1497

Rally Excellent B

1464, 1468, 1469, 1479, 1482, 1483, 1485, 1486, 1487,
1489, 1492

Rally Excellent A

1475, 1477

Rally Advanced B

1464, 1465, 1467, 1468, 1469, 1470, 1471, 1473

Rally Advanced A

1453, 1454, 1457, 1458, 1459, 1461, 1462, 1463

Rally Intermediate

1436, 1437, 1439, 1441, 1442, 1443, 1447

Rally Novice B

1430, 1431

Rally Novice A

1400, 1401, 1403, 1404, 1405, 1408, 1409, 1411, 1412,
1413, 1414, 1415, 1416, 1417, 1418, 1420, 1423

RALLY OBEDIENCE FRIDAY TRIAL #2

Ring 17 - Tami Marks

8:00a.m.

Rally Master

1484, 1486, 1488, 1490, 1494, 1495, 1497

Rally Excellent B

1464, 1469, 1480, 1481, 1485, 1486, 1488, 1490

Rally Excellent A

1476, 1478

Rally Advanced B

1464, 1465, 1467, 1469, 1473, 1474

Rally Advanced A

1443, 1453, 1454, 1456, 1457, 1458, 1459, 1461, 1462,
1463

Rally Intermediate

1436, 1437, 1438, 1441, 1442, 1446, 1450

Rally Novice B

1426, 1427, 1430, 1432, 1433, 1434, 1435

Rally Novice A

1400, 1401, 1403, 1404, 1405, 1408, 1409, 1410, 1411,
1413, 1416, 1420, 1423

OBEDIENCE FRIDAY TRIAL #1

Ring 18 - Suzanne Hemminger

8:00a.m.

Obedience Utility B

1324, 1328, 1335

Obedience Utility A

1333, 1334

Obedience Open HA

1330, 1331

Obedience Open 18B

1324, 1325, 1327, 1328

Obedience Open 18A

1321, 1323

Obedience Novice B

1316, 1317

Obedience Novice A

1311, 1312, 1313, 1314

Obedience Pre-Novice

1302, 1303, 1304, 1305, 1309

Ring 18 - Suzanne Hemminger
12:30p.m.

DOBERMAN PINSCHER CLUB OF CANADA RALLY
AND OBEDIENCE SPECIALTY

Judging Location:

TBL

TBL/RMP

RMP

RMP/GND

GND

JUDGING SCHEDULE - Alberta Kennel Club [SUMMER CLASSIC]

Rally and Obedience Trials - Saturday, August 05, 2023

The Obedience Schedule is based on 9 dogs per hour in Pre-Novice, 8 dogs per hour in Novice, 7 dogs per hour in Open and 6 dogs per hour in Utility.
The Rally O Schedule is based on 15 dogs per hour as well as 10 minutes to reset between Novice, Advanced, Excellent and Master and a 10-minute Walk Through.

Breaks will be at the judge's discretion

RALLY OBEDIENCE SATURDAY TRIAL #3 Ring 16 - Suzanne Hemminger

8:30a.m.

Rally Master

1466, 1468, 1479, 1482, 1483, 1484, 1486, 1487, 1488,
1492, 1493, 1494, 1495, 1496

Rally Excellent B

1464, 1466, 1468, 1479, 1480, 1481, 1482, 1483, 1484,
1486, 1487, 1488, 1489, 1492

Rally Excellent A

1475, 1476

Rally Advanced B

1464, 1466, 1468, 1470, 1471, 1473, 1474

Rally Advanced A

1443, 1452, 1453, 1454, 1457, 1458, 1460, 1461, 1462,
1463

Rally Intermediate

1436, 1437, 1438, 1440, 1442, 1444, 1447, 1448, 1449,
1451

Brace

1470 / 1474, 1489 / 1498

RALLY OBEDIENCE SATURDAY TRIAL #3 Ring 17 - Marion Postgate

9:00a.m.

Rally Novice B

1425, 1426, 1427, 1428, 1429, 1431, 1432, 1433, 1434

Rally Novice A

1400, 1401, 1402, 1403, 1406, 1407, 1409, 1410, 1411,
1412, 1414, 1416, 1417, 1418, 1419, 1420, 1421, 1422,
1423

OBEDIENCE SATURDAY TRIAL #3 Ring 17 - Marion Postgate

12:30p.m.

Obedience Utility A

1334

Obedience Open 18A

1321

Obedience Novice B

1320

Obedience Novice A

1311, 1312, 1314

Obedience Pre-Novice

1309

OBEDIENCE SATURDAY TRIAL #2 Ring 18 - Cheryl Bishop

8:30a.m.

Obedience Utility B

1324, 1328

Obedience Utility A

1333, 1334

Obedience Open 18B

1324, 1325, 1327, 1328, 1329

Obedience Open 18A

1321, 1322, 1323

Obedience Open HB

1332

Obedience Open HA

1330

Obedience Novice B

1319, 1320

Obedience Novice A

1307, 1308, 1310, 1311, 1313, 1314, 1315

Obedience Pre-Novice

1300, 1301, 1304, 1305, 1309

Judging Location:

TBL

TBL/RMP

RMP

RMP/GND

GND

JUDGING SCHEDULE - Alberta Kennel Club [SUMMER CLASSIC]

Rally and Obedience Trials - Sunday, August 06, 2023

The Obedience Schedule is based on 9 dogs per hour in Pre-Novice, 8 dogs per hour in Novice, 7 dogs per hour in Open and 6 dogs per hour in Utility.
The Rally O Schedule is based on 15 dogs per hour as well as 10 minutes to reset between Novice, Advanced, Excellent and Master and a 10-minute Walk Through.

Breaks will be at the judge's discretion

RALLY OBEDIENCE SUNDAY TRIAL #4 Ring 16 - Marion Postgate

8:30a.m.

Rally Master

1466, 1468, 1479, 1482, 1484, 1486, 1490, 1491, 1493,
1494, 1495, 1496

Rally Excellent B

1464, 1466, 1468, 1479, 1481, 1482, 1484, 1486, 1489,
1490, 1491

Rally Excellent A

1475, 1476, 1477

Rally Advanced B

1464, 1466, 1468, 1470, 1473, 1474

Rally Advanced A

1443, 1453, 1456, 1458, 1459, 1460, 1461, 1462, 1463

Rally Intermediate

1436, 1437, 1438, 1442, 1446, 1447, 1451

Rally Novice B

1429, 1431, 1434

Rally Novice A

1400, 1403, 1406, 1409, 1411, 1412, 1416, 1421, 1422,
1423, 1424

RALLY OBEDIENCE SUNDAY TRIAL #5 Ring 17 - Cheryl Bishop

10:15a.m.

Rally Novice A

1400, 1406, 1410, 1416, 1417, 1418, 1422

Rally Novice B

1426, 1427, 1429, 1430

Rally Intermediate

1436, 1437, 1442, 1444, 1445, 1450, 1451

Rally Advanced A

1453, 1459, 1460, 1461, 1462, 1463

Rally Advanced B

1464, 1467, 1472, 1473

Rally Excellent B

1464, 1479, 1480, 1486, 1487

Rally Master

1479, 1486, 1487, 1493, 1494, 1495

OBEDIENCE SUNDAY TRIAL # 4 Ring 18 - Suzanne Hemminger

8:30a.m.

Obedience Pre-Novice

1305, 1306

Obedience Novice A

1310, 1311, 1313, 1314

Obedience Novice B

1317

Obedience Open 18A

1321, 1322

Obedience Open 18B

1324, 1325, 1328

Obedience Open HA

1331

Obedience Open HB

1332

Obedience Utility A

1333, 1334

Obedience Utility B

1324, 1328, 1335

Veteran's

1331

Judging Location:

TBL

TBL/RMP

RMP

RMP/GND

GND

JUDGING SCHEDULE - Alberta Kennel Club [SUMMER CLASSIC]

Rally and Obedience Trials - Monday, August 07, 2023

The Obedience Schedule is based on 9 dogs per hour in Pre-Novice, 8 dogs per hour in Novice, 7 dogs per hour in Open and 6 dogs per hour in Utility.
The Rally O Schedule is based on 15 dogs per hour as well as 10 minutes to reset between Novice, Advanced, Excellent and Master and a 10-minute Walk Through.

Breaks will be at the judge's discretion.

RALLY OBEDIENCE MONDAY TRIAL #6

Ring 17 - Suzanne Hemminger

8:30a.m.

Rally Master

1479, 1486, 1487, 1490, 1491, 1492, 1493, 1494, 1495, 1496

Rally Excellent B

1464, 1479, 1480, 1486, 1487, 1489, 1490, 1491, 1492

Rally Excellent A

1475, 1476

Rally Advanced B

1464, 1465, 1467, 1470, 1474

Rally Advanced A

1452, 1453, 1455, 1456, 1461, 1462

Rally Intermediate

1436, 1438, 1444, 1446, 1447

Rally Novice B

1426, 1427, 1430

Rally Novice A

1411, 1416, 1418, 1420, 1423

OBEDIENCE MONDAY TRIAL #5

Ring 18 - Cheryl Bishop

8:30a.m.

Obedience Utility B

1326, 1328, 1335

Obedience Utility A

1333, 1334

Obedience Open HA

1331

Obedience Open 18B

1326, 1327, 1328, 1329

Obedience Open 18A

1321

Obedience Novice B

1318

Obedience Novice A

1311, 1314

Obedience Pre-Novice

1304, 1309

Judging Location:

TBL

TBL/RMP

RMP

RMP/GND

GND



Chipperfield
CHIPPERFIELD PHOTOGRAPHY

JENNIFER CHIPPERFIELD
403.860.0556.
WWW.CHIPPERFIELDPHOTOGRAPHY.COM

THE OFFICIAL AGILITY PHOTOGRAPHER FOR THE AKC SUMMER CLASSIC



Thank-you to our Sponsors of the 2023 Summer Classic

Gold Sponsors



Silver Sponsor



Open Sponsors



Thank-You to our Trophy Fund Donors

David CARICH
Lynne FENNELL
Pearl HUMENNY
Carolina KOUTRAS
Taylor MCWADE

Jeannie MISKEY
Sandra MOORE
Hilary OAKES
Len ROGERS
Lynette RUSSELL

Caroline SHERET
Echo SMITH
T.R. TURNER
Tara WILKIE



PLATINUM BREEDER PROGRAM



ROYAL CANIN® formulas are developed with your breed's unique needs in mind for optimal body condition, coat health and digestion. As a breed expert, you know the right nutrition can unlock the magnificence inside, and so do we.

- Royal Canin PRO nutrition at **breeder-exclusive pricing**
- **Recommendation Kits** for new puppy and kitten owners
- Access to **Optimal Selection Genetic Health DNA testing kits**
- **Points awarded for your recommendation**, with the opportunity to earn diagnostic services



- Free access to the **Recommendation Portal**
- Free access to the **Royal Start Kennel/Cattery Management Software**



SIGN UP. START SAVING. | pro.royalcanin.ca





A PROGRAM CANADIAN BREEDERS CAN TRUST!

We support our breeder partners and their passion for nurturing healthy litters.

- There is no cost to join the Breedsecure program.
- Provide new puppy owners with a complimentary six-week insurance trial.
- Alleviate vet costs associated with health guarantees.

Contact your Breedsecure representative for more details at breeders@petsecure.com or visit breedsecure.ca.

Not a breeder?

Visit petsecure.com to discover the benefits of pet insurance!



Petsecure is available to residents of Canada and provides coverage to eligible pets, subject to the Policy Wordings. Breedsecure trial coverage is subject to a 48-hour waiting period from the date and time of activation, and is subject to the Terms and Conditions provided upon activation. Terms, conditions, limitations, and exclusions will apply. Please refer to your policy documents for full details of your coverage. In the event of a discrepancy between the content of this document and your policy documents, the policy documents will govern. ©2022 Petline Insurance Company. All Rights Reserved. Petsecure is underwritten by Petline Insurance Company.

FRESH

APPROACH RENOVATIONS

Complete Home Renovations



With over 40 years of positive Fresh experience alongside our team, we can create beautifully Fresh living spaces for you to enjoy. After long days and busy weeks, we can create the spaces for you to enjoy. Kitchens and baths are our absolute favourite. We include basements, decks, and outdoor living as some of our most interesting to build. Our team is waiting to work with you.



www.farenos.ca

info@farenos.ca

403.620.9502

Echocardiogram with Color Flow Doppler Breed Screen Clinic

Open to Purebred Registered Dogs of All Breeds

With Board-Certified Cardiologist,
Dr. Luis Braz-Ruivo DVM, DVSc, ACVIM (Ca)
Dates: August 4, 5, & 6, 2023

Location: North American Ring Viewing Building, Spruce Meadows,
18011 Spruce Meadows Way SE, Calgary, Alberta, T2J 5G5
Held in conjunction with the AKC All Breed Show

Echo Cost: \$275.00 per dog prior to/on the registration deadline.

For more information please contact:

Cindy Thomas / Karen LeJeune
219 - 5344 76 Street, Red Deer, AB. T4P 2A6
drluisbrazruivoab@gmail.com

Cindy's Phone: 403-346-9848 / Karen's Phone: 403-318-3358

Information & Registration form will be posted on Canuck Dogs and the DogShow.ca

PROFESSIONAL CARE FROM THE VERY START

TO SUPPORT GROWTH IN THE CRUCIAL EARLY DAYS

PUPPY PROTECH



SCIENTIFICALLY
PROVEN

PATENT PENDING



FIRST MILK REPLACER
(BIRTH - 24H)

CONTINUED SUPPORT
(24H - WEANING)



HARMONIOUS
GROWTH



DIGESTIVE
HEALTH



ADDED
DHA

ROYAL CANIN®



Available in 300g

OFA Eye Certification

Dr. Brian Skorobohach DVM, DACVO

Friday, August 4, 2023

9 am - 5 pm

- Cost - \$45 per dog for OFA exam (Pre-Registered - Pre-registration closes July 22)
\$55 per dog for OFA Exam (Walk-In)
\$60 per dog for Gonioscopy
Payment will be received at the clinic - Cash or credit card accepted
- Location- North American Viewing Building, Spruce Meadows
- Scheduling- **E-mail eyes.care@vca.com**
We need to know the **number of dogs** you need examined
Allow 48 to 72 hours for a reply (Tuesday through Friday)
If having gonioscopy done let us know how many dogs as this takes extra time
- Registration - Dr Skorobohach is using OFA Online to fill out CAER eye exam results
Visit www.ofa.org/online to create your application form
Once you have your **registration number(s)** e-mail it to eyes.care@vca.com
This is vital information as it will keep the clinic running smoothly and on time
No paper copies, only online registrations will be accepted
- Exam - **Arrive 30 minutes early to your appointment time**
Exam is done 20 to 30 minutes after dilating drops are placed on the eyes
Dilation typically lasts 4-6 hours.
- Note - The following breeds are recommended to have a preliminary examination prior to initial pharmacological dilation to best facilitate identification of certain disorders
- Australian Shepherd
 - Dalmatian
 - Louisiana Catahoula Leopard Dog
 - Miniature American Shepherd
 - Miniature/Toy Australian Shepherd
- Note - The Eye Certification exam consists of indirect ophthalmoscopy and slit lamp Biomicroscopy. It is not a comprehensive ocular health examination, but rather an eye screening exam



Trinity Hills 24^{hr} PET + HOSPITAL

Saturday, August 5 and Sunday, August 6, 2023

Alberta Kennel Club's All Breed Championship Shows – Spruce Meadows, Calgary Alberta

SEMEN COLLECTION – EVALUATION – FREEZING AND HEALTH CLINIC

with Dr. Heather Suttie, DVM

Offering clinic service for your convenience (SHOW PRICES ONLY)

SEMEN SERVICES

Semen Collection and Evaluation (with morphology)	\$120.00
Semen Collection for Freezing (with 1 year storage)	\$400.00

BLOOD SERVICES

OFA Thyroid	\$220.00
Brucella	\$140.00
Idexx Titre Testing (Distemper and Parvovirus)	\$155.00

OTHER SERVICES

OFA Patella Luxation	\$ 85.00
OFA Cardiac (Basic Auscultation)	\$ 85.00
SHOW SPECIAL – BOTH PATELLA AND CARDIAC	\$115.00

Breed Specific DNA Testing through Pawprint Genetics

<https://www.pawprintgenetics.com/>

Advise of test(s) wanted:

Dependent on
number of tests
ordered per dog.

(There is a discount when multiple tests are ordered per dog)

AKC DNA Profile (stud dogs only) (price includes shipping) (Limited number – only 4 available)	\$80.00CAD PANTOPRAZOLE
---	-----------------------------------

TO REGISTER OR FOR MORE INFORMATION
PLEASE CONTACT MARNI AT 403-233-2888 OR Repro@thph.ca

Application Form

OWNER INFORMATION

Name:	Address:
Email:	
Phone: h)	Phone: c)

CANINE INFORMATION

Registered Name:	
Call Name:	Date of Birth:
Breed:	Colour:
Reg #:	Microchip/Tattoo:

REQUESTED PROCEDURE(S):

- Semen Collect/Evaluate Semen Collect/Evaluate/Freeze OFA Thyroid
 Brucella Idexx Titre Testing OFA Patella Luxation OFA Cardiac

AKC DNA Profile DNA Testing Requested test(s):

Preferred Date of Appointment (Saturday or Sunday): _____

Morning or Afternoon Preferred: _____

Are you competing on this day? _____

**** We understand that some appointments will need to be made around ring times and will do our best to accommodate once the judging/performance schedule is published. Please contact us with special requests.**

PAYMENT INFORMATION:

CREDIT CARD NUMBER: _____

EXPIRY: _____ CVV: _____

NAME ON CARD: _____

SIGNATURE: _____



**RESPIRATORY FUNCTION GRADING
SCHEME (RFGS) CLINIC**

Bulldogs, French Bulldogs, Pugs

August 5 & 6, 2023

9:00 am - 4:30 pm

Dr. Matt Wittenrich

Held in conjunction with

**Alberta Kennel Club Summer
Classic Dog Shows**

SPRUCE MEADOWS

18011 Spruce Meadows Way SW, Calgary, AB T2X 4B7

Testing Fee: \$70 (\$15 OFA fee NOT included)

Pre-Registration is Required using OFA Online: <https://online.ofa.org>
Go to your account, or create one, then pick the dog you want tested, select the
RFGS clinic date and fill out the application.

Email: ypoire@yahoo.com to set up an appointment.

For more info, contact: Pat O'Keefe monitaps@telusplanet.net
and Richard Paquette Zone4Director@ckc.ca

SPACE IS LIMITED, LAST CLINIC FILLED QUICKLY, DON'T MISS OUT!

The Examination

1. A short health survey regarding the dog's breathing history.
2. A brief physical exam while the dog is calm including auscultation where the assessor listens to the dog's breathing with a stethoscope gently positioned on the side of the neck. This establishes a baseline for any clinical signs of BOAS.
3. A short exercise testing consisting of a brisk three-minute walk. This is designed to expose clinical signs of the disease in an otherwise calm and asymptomatic dog. It is not designed to assess cardiovascular fitness.
4. A post exercise auscultation after increased airway activity to compare to the pre-exercise baseline.

RFG Scheme Screening

The noise the trained veterinarians are listening for during auscultation include:

- **Stertor** - a low pitched vibrational noise heard above the level of the larynx
- **Stridor** - higher pitched 'sawing' noise heard over the larynx
- **Nasal sterter** - low pitched nasal snort/vibration
- **Nasal stridor** - high pitched nasal whistle, usually on breathing in

RFG Scheme - What Does the Grading Mean?

The Respiratory Function Grading Scheme (RFGS) utilizes a sliding scale of 0 to 3 to objectively diagnosis BOAS:

- **Grade 0** - the dog is clinically unaffected and free of respiratory signs of BOAS (no evidence of disease, no BOAS related noise heard even with a stethoscope)
- **Grade 1** - the dog is clinically unaffected but have mild respiratory signs linked to BOAS (noise is mild and only audible with a stethoscope)
- **Grade 2** - the dog is clinically affected and has moderate respiratory signs of BOAS (noise is audible even without a stethoscope)
- **Grade 3** - the dog is clinically affected and has severe respiratory signs of BOAS (noise is audible even without a stethoscope)

Publication of Results

Grade 0 and Grade 1 - are considered clinically normal and BOAS unaffected as they exercise without difficulty and do not appear to have any clinical signs related to airway obstruction.

Clinically normal dogs (**Grade 0 and 1**) will receive OFA certificate numbers, and their results will be posted on the OFA website.

Grade 2 and Grade 3 - when stertor or stridor noise is heard without a stethoscope, whether intermittent or continuous, these dogs are considered affected with clinical signs affecting their quality or life.

Grade 2 or 3 results will only be posted on the OFA website if their owners authorize release of abnormal data.

BOAS Breeding Recommendations

Using the RFG Scheme grades are the guidelines in the chart, concerned responsible breeders can apply the selective genetic pressure to reduce the chances of producing puppies affected by BOAS.

However, since the inheritance of BOAS is not fully understood and is not entirely predictable, this guideline cannot guarantee that all puppies from unaffected parents will be free of BOAS.

Ultimately, responsible breeders use the RFG Scheme to screen their breeding stock and include the results in their selection criteria.

		DOG ONE (sire or dam)			
		Grade 0	Grade 1	Grade 2	Grade 3
DOG TWO (sire or dam)	RFG Grade for each dog				
	Grade 0				
	Grade 1				
	Grade 2				
Grade 3					

- Green** - These mating combinations have the lowest risk of producing puppies effected by BOAS
- Yellow** - A Grade 2 or 3 mating will increase th risk of producing puppies affected by BOAS
- Red** - These mating combinations have a high risk of producing puppies affected by BOAS and are not recommended

Site Map

AKC - Summer Classic 2023
Entrance off Spruce Meadows Green SW to Tournament Lane
(watch for Construction signs)

N

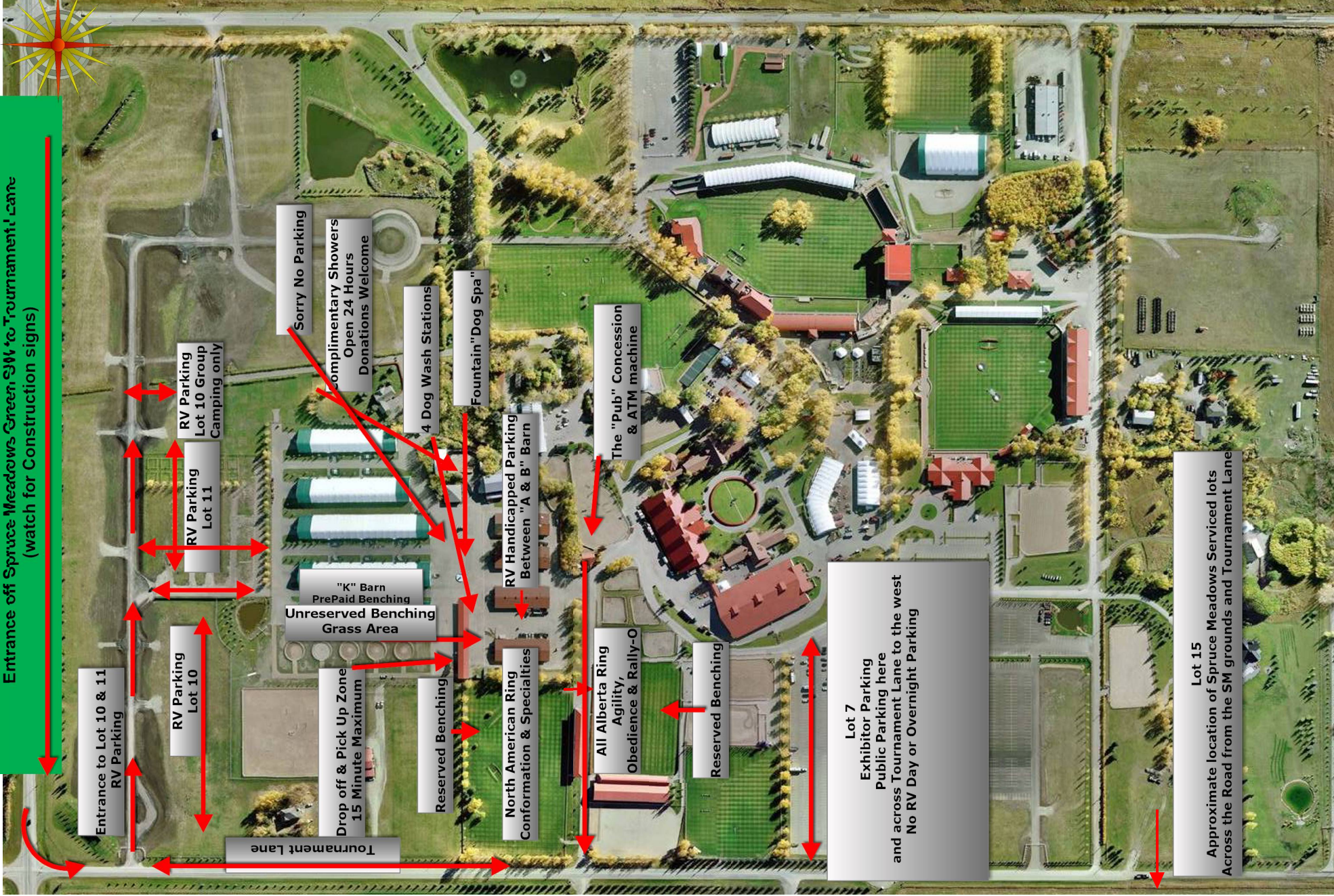

Entrance to Lot 10 & 11
RV Parking

RV Parking
Lot 10

RV Parking
Lot 11

RV Parking
Lot 10 Group
Camping only

Tournament Lane

Drop off & Pick Up Zone
15 Minute Maximum

"K" Barn
PrePaid Benching
Unreserved Benching
Grass Area

Reserved Benching

North American Ring
Conformation & Specialties

RV Handicapped Parking
Between "A & B" Barn

4 Dog Wash Stations

Fountain "Dog Spa"

Sorry No Parking
Complimentary Showers
Open 24 Hours
Donations Welcome

All Alberta Ring
Agility,
Obedience & Rally-O

Reserved Benching

The "Pub" Concession
& ATM machine

Lot 7
Exhibitor Parking
Public Parking here
and across Tournament Lane to the west
No RV Day or Overnight Parking

Lot 15
Approximate location of Spruce Meadows Serviced lots
Across the Road from the SM grounds and Tournament Lane



Subject to Change

No Day Benching Area

No Day Benching Area

No Day Benching Area

Gate to Washbays

North American Viewing Building

South

Gate

No Day Benching Area

- Kochland Club of Canada 20' x 30' Sides
- Schizophrenic Club of Canada 20' x 15' Sides
- Arctic 15' x 15' Sides
- Canadian Club of Canada 20' x 30' Sides
- Stafordshire Bull Terrier Club of Canada 20' x 30' Sides
- Shiba Inu Specialty Tent 20' x 20' Sides
- Alberta Toy 20' x 20' Sides
- French Bulldog Club of Canada 20' x 30' Sides
- Pharos Club of Canada 20' x 30' Sides

- All Terrier Club of Canada Specialty Tent 20' x 20' Sides
- Spanning Dog Specialty Tent 20' x 20' Sides

Flag Poles

1	2	3	4	5	6	7	8	9	10	11	12	13
14	15	16	17	18	19	20	21	22	23	24	25	26
27	28	29	30	31	32	33	34	35	36	37	38	39
40	41	42	43	44	45	46	47	48	49	50	51	52
53	54	55	56	57	58	59	60	61	62	63	64	65

10 Space Between back of Vendor Tents and Day Benching

Water Jump
46' x 20'

Janine Starink
Photography Display

Janine Starink
Photographer
Power Required

Slope



Flag Poles

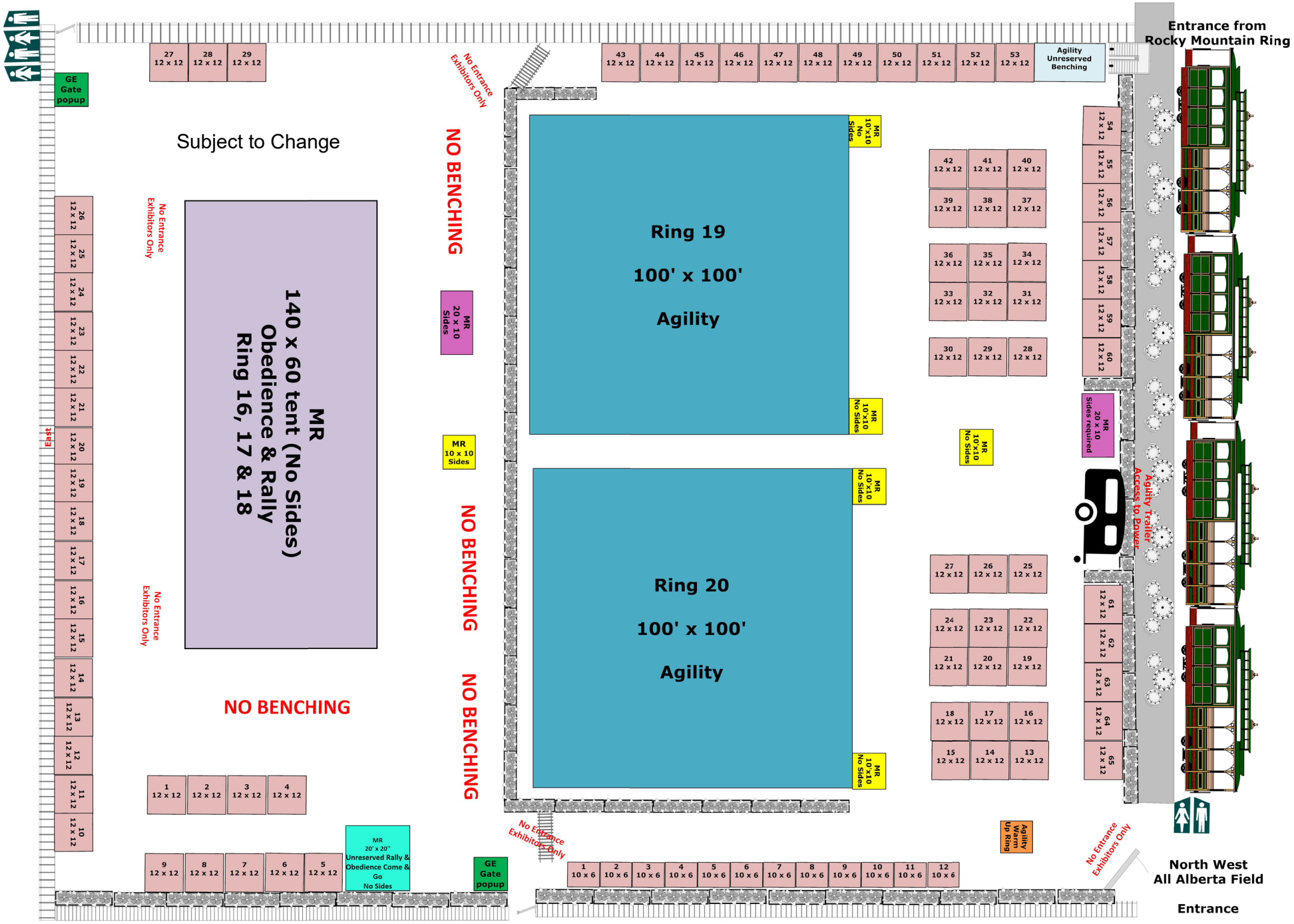

Entrance from Rocky Mountain Ring

North West All Alberta Field Entrance

Entrance

Subject to Change

MR
140 x 60 tent (No Sides)
Obedience & Rally
Ring 16, 17 & 18

Ring 19
100' x 100'
Agility

Ring 20
100' x 100'
Agility

NO BENCHING

NO BENCHING

NO BENCHING

NO BENCHING

All Alberta Field
Across from North American Field
Entrance

Agility Trailers
Access to Entrance

Agility Unreserved Benching

Agility Warm Up Ring

No Entrance Exhibitors Only

No Entrance Exhibitors Only

No Entrance Exhibitors Only

No Entrance Exhibitors Only

No Entrance Exhibitors Only

Exit

GE Gate popup

GE Gate popup

MR 20' x 20'
Unreserved Rally & Obedience Come & Go
No Sides

27 12 x 12
28 12 x 12
29 12 x 12

43 12 x 12
44 12 x 12
45 12 x 12
46 12 x 12
47 12 x 12
48 12 x 12
49 12 x 12
50 12 x 12
51 12 x 12
52 12 x 12
53 12 x 12

54 12 x 12
55 12 x 12
56 12 x 12
57 12 x 12
58 12 x 12
59 12 x 12
60 12 x 12

MR 20 x 10
Sides required

61 12 x 12
62 12 x 12
63 12 x 12
64 12 x 12
65 12 x 12

42 12 x 12
41 12 x 12
40 12 x 12

36 12 x 12
35 12 x 12
34 12 x 12

33 12 x 12
32 12 x 12
31 12 x 12

27 12 x 12
26 12 x 12
25 12 x 12

24 12 x 12
23 12 x 12
22 12 x 12

18 12 x 12
17 12 x 12
16 12 x 12

36 12 x 12
35 12 x 12
34 12 x 12
33 12 x 12
32 12 x 12
31 12 x 12
30 12 x 12
29 12 x 12
28 12 x 12
27 12 x 12
26 12 x 12
25 12 x 12
24 12 x 12
23 12 x 12
22 12 x 12
21 12 x 12
20 12 x 12
19 12 x 12
18 12 x 12
17 12 x 12
16 12 x 12
15 12 x 12
14 12 x 12
13 12 x 12
12 12 x 12
11 12 x 12
10 12 x 12

1 12 x 12
2 12 x 12
3 12 x 12
4 12 x 12

1 10 x 6
2 10 x 6
3 10 x 6
4 10 x 6
5 10 x 6
6 10 x 6
7 10 x 6
8 10 x 6
9 10 x 6
10 10 x 6
11 10 x 6
12 10 x 6

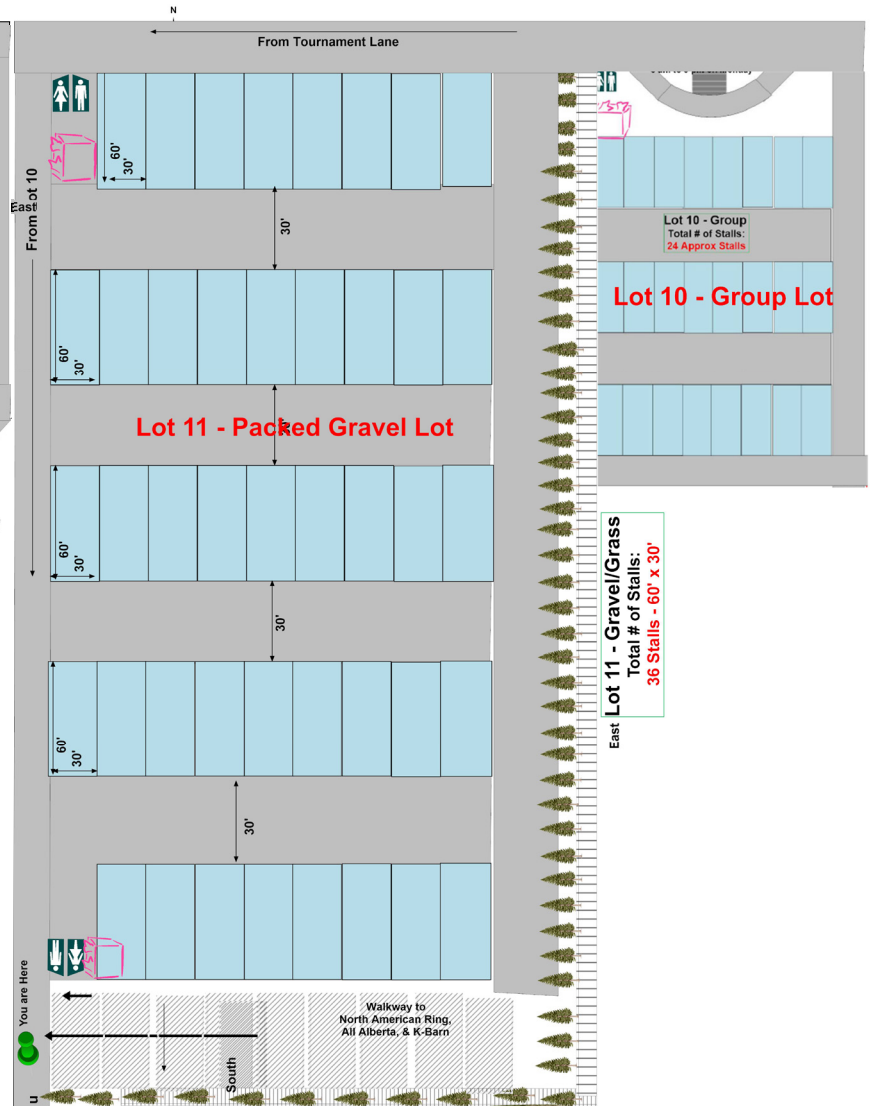
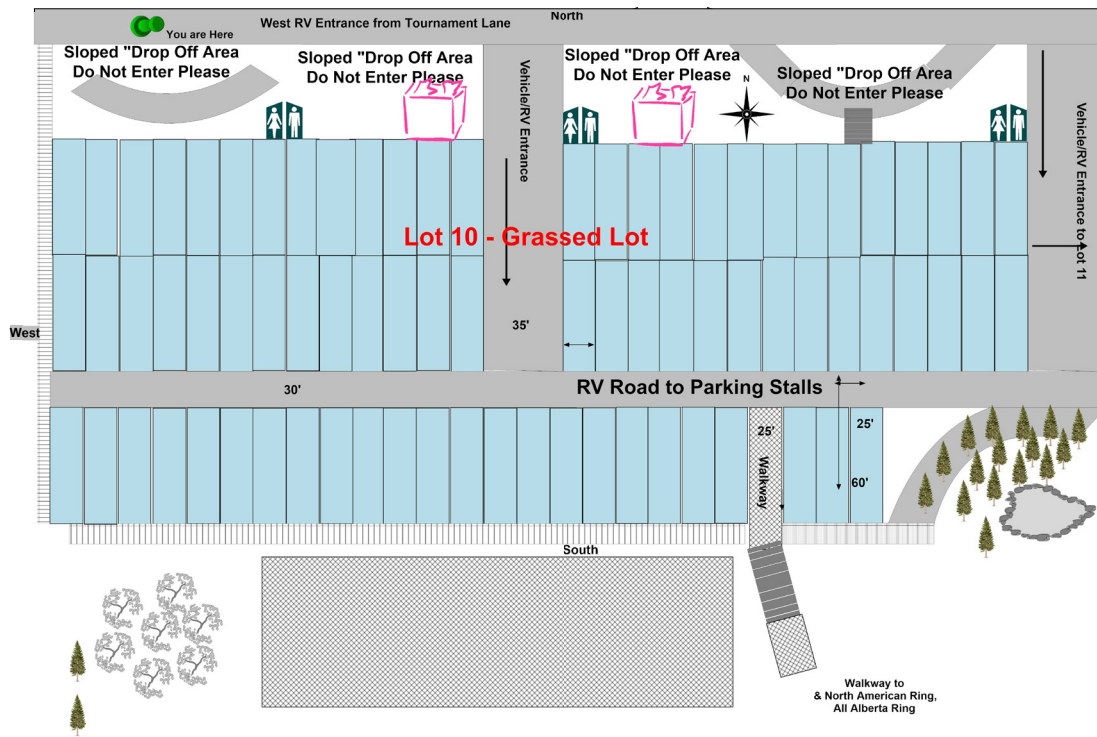

East Lot 11 - Gravel/Grass
 Total # of Stalls:
 36 Stalls - 60' x 30'

Lot 10 - Group
 Total # of Stalls:
 24 Approx Stalls

Lot 10 - Group Lot

**The Alberta Kennel Club is actively recruiting!
We are looking for committed dog fanciers who
want to help us continue to present a
premier dog event in the coming years.**

WANTED!!! YOU!!!

**Opportunities within the Club vary from Media Relations
to Judges' Committee to Advertising and Sponsorship
and much more!**



**If this could be YOU,
please drop by the Show Secretary's desk
for further information.**



Mental Skills Training for Agility Competitions

Book your interview here:



Research Participants Needed

Do you compete in agility with your dog and use mental skills training such as imagery, goal setting or relaxation techniques to enhance your performance?

Then this is a great opportunity for you to share your experience during an online interview and help further research around agility, performance and psychology.



Eligibility Criteria

- Current Agility competitor (any level)
- Over 18 years of age
- Use of mental skills approaches (e.g., breathing exercises)



Location

- Online via MS Teams (no own account necessary)
- Virtual 1:1 interview lasting around 45-90 minutes